

Staffordshire

County Council

PUBLIC RIGHT OF WAY EVIDENCE FORM **Important Note**

The object of this enquiry is simply to reach the truth of the matter, whatever it may be. Witnesses are therefore asked to answer the questions as fully as possible and not to keep back any information, whether for or against the public status claim. This is of particular importance if the information is to be of real value in establishing the status of the way.

Name of witness (Mr/Mrs/Miss/Ms)..... DEBORAH GARNSEY.....

Please attach a map showing the claimed way marked in red, signed by yourself.

Guidance Notes on the completion of Public Rights of Way Evidence Forms

1. As far as possible the witness should complete the form, preferably in black ink. If another individual completes the form on their behalf they should indicate this at the end of the form.
2. Each witness should answer all questions fully with as much detail as possible.
3. Each witness should complete a separate form in respect of each claimed right of way about which she/he can give evidence.
4. A plan must be attached and the witness should clearly draw the route of the claimed right of way on the plan, and initial the plan at each end of the drawn route.
5. The route of the claimed right of way should be described as accurately as possible, if possible giving details of such things as property and field boundaries, stiles, gates, bridges and stepping stones, etc.
6. Witnesses should indicate whether they are prepared to give evidence either in a court or at a public inquiry. (The evidential value of a statement is reduced if it cannot be subject to cross examination).
7. If a witness would be unable to give evidence at a hearing because of ill health, age, etc the person obtaining the statement should endorse the form accordingly, and be able to give evidence of the circumstances.
8. The information given on this form may become available for public inspection.

Description of claimed way:- (include grid references if known)

From

To

Please take time to answer the questions carefully and in full

1. (a) How many years have you known the way? 28 years
(b) Does the way have a popular name? Hedgwood Lane
(c) Have you personally used the above way? *YES/NO
(d) Did you only use part of the way? *YES/NO

Please do not use vague terms such as "often".

- (e) During which years have you used the way? From 1986 To 2009
(f) Where were you going from/to? Mossley and Congleton Edge RD to BV Way
at home
(g) For what purpose? (eg work, pleasure) Pleasure
(h) How many times a year? (eg daily, weekly, seasonal) Seasonal - weekly, a business
(i) By what means? (eg on foot, horseback, motor vehicle etc) Horse back
(j) Is, or was, the way a short cut for you? None - an alternative route
(k) If so why? Off road so no vehicles - a pleasant
way to join the B.V. Way

(l) **Please show on the attached plan the route of the way you have used.**
If you have only used part of the way please mark or indicate the part used.

- (m) Do you still use the way? No
(n) If not why not? I no longer ride horses.

2. When using the path where did you live? Crossfields, Crossfields Lane
Mossley Congleton
If at different places please provide details and years.

3. (a) How wide is the way? Approximately 2-3 metres
(b) Is it the same width throughout its length? As far as I recall

4. If you have ridden a horse on the way
(a) Where did you keep the horse? At home (as above)
(b) Where did you start and finish your ride? Home - home
(c) Were you ever riding with the hunt when you used the way? No

5. (a) When using the way did you ever see any other person driving motor or horse-drawn vehicles on the way? *YES/NO
- (b) If YES, how often and what type of vehicle were they using?
- (c) Have you ever driven, or been a passenger in, a motor or horse drawn vehicle on the way? *YES?NO
- (d) If YES to (c),
- (i) How often was this?
- (ii) What type of vehicle were you in?
- (iii) For what purpose was it being used?
-

6. (a) Has the way always been on the same route? *YES/NO
- (b) If NO, please describe the original route, state when the way was diverted and show details on a plan.
- (c) Is the way a clearly defined track or path which a stranger to the vicinity could follow? *clearly defined*
- (d) Have you always kept to the route of the way between the start and finish, or have you wandered from the route? *kept to the route*
-

7. (a) Have there, to your knowledge, ever been any stiles on the way? *YES/NO
- (b) Have there, to your knowledge, ever been any gates on the way *YES/NO
- (c) If YES, please mark on the attached plan the location of the stiles or gates and state, if known, when they were erected or removed.
- (d) If any gates on the way were ever locked please state, how often, and if known, by whom?
- Please mark on the attached plan the locations of the locked gates.
-

8. (a) Excluding locked gates, have you ever known of any other obstructions to the way? *YES/NO
- (b) If YES, state (i) what type of obstruction was this?
- (ii) When they were erected or removed?
- (c) Please state, if known, who erected the obstructions and show the approximate position of the obstructions on the attached plan.

9. Has your usage ever been hindered or prevented in any way? *YES/NO
- If so by whom or what?
- When was this?
- Have you continued to use the way despite hindrances or obstructions *YES/NO
- How did you do this? (e.g. diversion)
- Is the hindrance or obstruction still in existence *YES/NO
-

10. (a) Were you ever an owner or tenant of the land crossed by the way? *YES/NO

If YES, please give dates.

- (b) If you were an owner or tenant did you acknowledge the route as a Public Right of Way? *YES/NO

If YES, please give dates.

- (c) Was the land ever owned or tenanted by a relative of yours? *YES/NO

If so, what was their relationship to you?

- (d) When you used the way were you working for any owner or tenant of the land adjoining or crossed by the way? *YES/NO

(e) If YES to (d),

(i) What was your employment?

(ii) Between what years were you employed?

(f) If you were employed by the owner/tenant

(i) Did you receive any instructions from the owner/tenant as to the use of the way by the public? *YES/NO

(ii) If so, what were your instructions?

(g) Did any relatives of yours ever work for an owner or tenant of land adjoining or crossed by the way? *YES/NO

If so, what was their relationship to you?

11. (a) Have you ever been stopped or turned back when using the way? *~~YES~~/NO

(b) Do you know, or have you heard of, anyone else having been prevented from using the way? *~~YES~~/NO

(c) If YES to (a) or (b), please give details including dates.
.....
.....

12. (a) Were you ever told by any owner or tenant of the land crossed by the way, or by anyone in their employment, that the way was not public? *~~YES~~/NO

(b) If YES, please state:
(i) Who told you?
(ii) When you were told?
(iii) What were you told?

13. (a) Have you ever seen any deterrent notices such as "Private", "No Road", "No Thoroughfare" or "Trespassers will be Prosecuted", on or near the way? *~~YES~~/NO

(b) If YES, please state what the notices said appropriate date of their display and show their approximate position on the attached plan? *~~YES~~/NO

14. (a) Have you ever seen any notices such as "Public Path", or "footpath", or any other similar notice on or near the way? *~~YES~~/NO

(b) Have you ever seen any direction signs, finger posts or other indicators on or near the way? *~~YES~~/NO

(c) If YES to (a) or (b), please state what the notices or posts said and show their approximate position on the attached plan?
.....

15. (a) Have you ever been given permission to use the way?
(Whether or not you asked for it) *YES/NO
- (b) Have you ever asked permission to use the way? *YES/NO
- (c) If YES, who gave you permission?
.....
- (d) When were you given permission?
- (e) For what purpose were you given permission to use the way?
-

16. (a) Have you seen other people using the way? *YES/NO
- (b) How were they using the way (ie foot, horse)? Both
- (c) Were they accompanying you? If so, please give details. (ie companions,
rambling club, family, etc)? companions on horseback
- (d) If they were not accompanying you, were these people known to you? Yes
- (e) How frequently did you see other people using the way? (ie daily, weekly,
seasonal etc) weekly in summer
- (f) How many other people, approximately, did you see on these occasions? 1-2
- (g) Please give any further details of other people's use of the way which you feel
may be important often used by local day walkers
-

17. Have you ever been charged a monetary sum for using the path?
If so, by whom? *YES/NO
-

18. (a) Do you have any documentary evidence about the way? *YES/NO
- (b) If so, in what form is this? ie maps, photos, etc please attach a copy if possible)
.....
- (c) Would you be willing to make the original document available
if necessary? N/A *YES/NO

19. Can you give any further information about the way (continue on a separate sheet of paper if necessary).

20. Would you be prepared to give evidence of your use of the way
at a public inquiry or in a court of law, if necessary?

*YES/NO

Please note that this form may be available to members of the public including affected owners or occupiers of the land crossed by the way.

I certify that, to the best of my knowledge and belief, the information I have given to this statement is true.

Signature: *[Handwritten Signature]*

Person taking this statement (if applicable) *N/A*

Date: *28/08/15*

CONCLETON EDGE
← (TRACTOR GRAVEYARD)

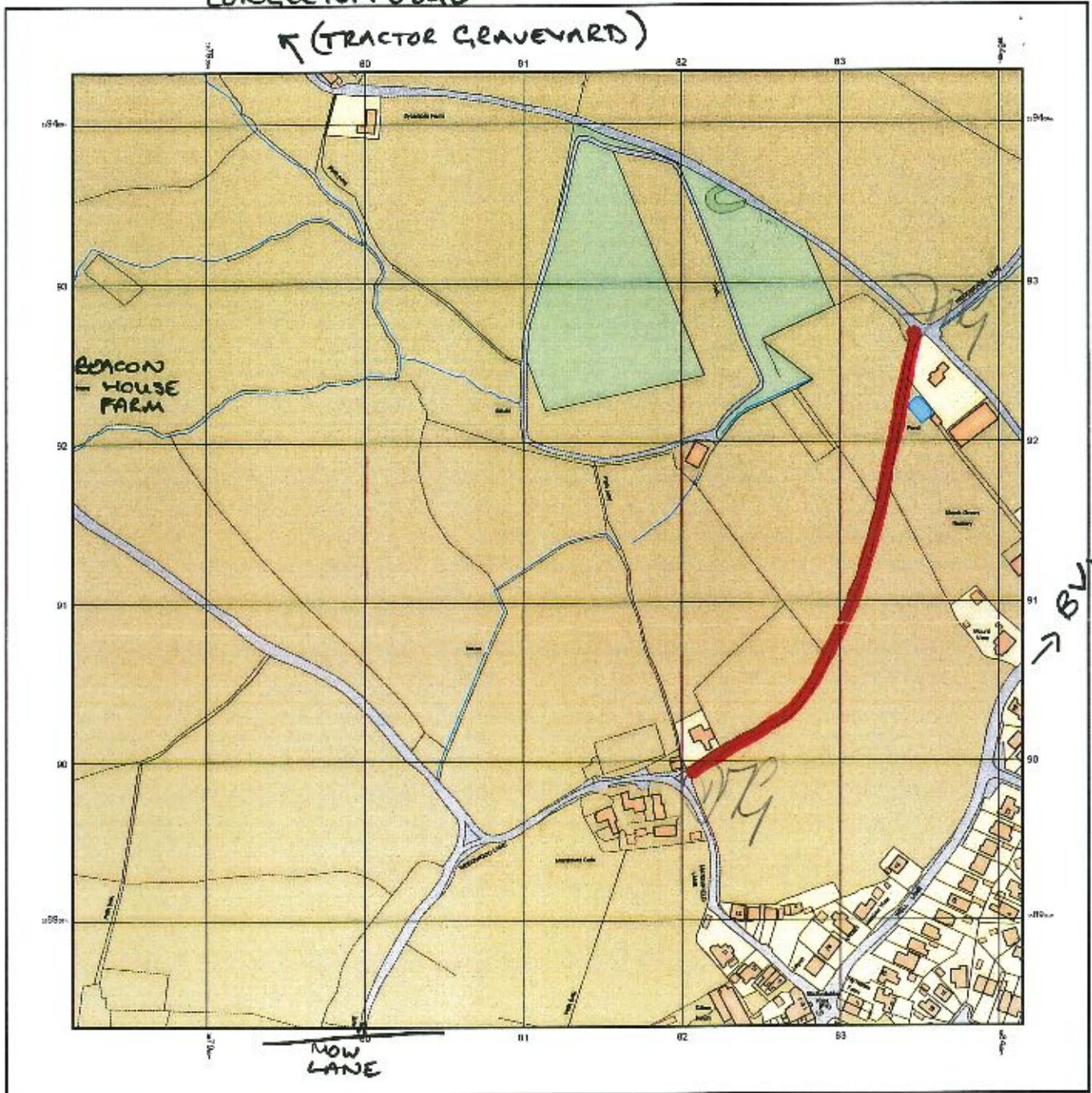

© Crown copyright and database rights 2015 Ordnance Survey 100048957. The representation of road, track or path is no evidence of a boundary or right of way. The representation of features as lines is no evidence of a property boundary.

Supplied by: www.ukmapcentre.com
Serial No: F6144
Centre Coordinates: 388115.359133
Production Date: 17/08/2015 15:05:19

THE ROUTE HIGHLIGHTED RED IS THE ROUTE I HAVE USED

SIGNED *[Signature]* DATE *19/10/15*
pp J. Carver (with permission)

Staffordshire

County Council

PUBLIC RIGHT OF WAY EVIDENCE FORM

Important Note

The object of this enquiry is simply to reach the truth of the matter, whatever it may be. Witnesses are therefore asked to answer the questions as fully as possible and not to keep back any information, whether for or against the public status claim. This is of particular importance if the information is to be of real value in establishing the status of the way.

Name of witness (Mr/Mrs/Miss/Ms).....MARGARET.....MARINKOVIĆ.....

Please attach a map showing the claimed way marked in red, signed by yourself.

Guidance Notes on the completion of Public Rights of Way Evidence Forms

1. As far as possible the witness should complete the form, preferably in black ink. If another individual completes the form on their behalf they should indicate this at the end of the form.
2. Each witness should answer all questions fully with as much detail as possible.
3. Each witness should complete a separate form in respect of each claimed right of way about which she/he can give evidence.
4. A plan must be attached and the witness should clearly draw the route of the claimed right of way on the plan, and initial the plan at each end of the drawn route.
5. The route of the claimed right of way should be described as accurately as possible, if possible giving details of such things as property and field boundaries, stiles, gates, bridges and stepping stones, etc.
6. Witnesses should indicate whether they are prepared to give evidence either in a court or at a public inquiry. (The evidential value of a statement is reduced if it cannot be subject to cross examination).
7. If a witness would be unable to give evidence at a hearing because of ill health, age, etc the person obtaining the statement should endorse the form accordingly, and be able to give evidence of the circumstances.
8. The information given on this form may become available for public inspection.

Description of claimed way:- (include grid references if known)

From

To

Please take time to answer the questions carefully and in full

1. (a) How many years have you known the way? 20 years
(b) Does the way have a popular name? .. WEDGEWOOD LANE
(c) Have you personally used the above way? *YES/NO
(d) Did you only use part of the way? *YES/NO

Please do not use vague terms such as "often".

- (e) During which years have you used the way? From..... To.....
(f) Where were you going from/to? .. PLEASURE RIDE - HOCK
(g) For what purpose? (eg work, pleasure) PLEASURE
(h) How many times a year? (eg daily, weekly, seasonal) SEASONAL
(i) By what means? (eg on foot, horseback, motor vehicle etc) .. HORSE BACK
(j) Is, or was, the way a short cut for you? No
(k) If so why?

(l) Please show on the attached plan the route of the way you have used.
If you have only used part of the way please mark or indicate the part used.

- (m) Do you still use the way? YES
(n) If not why not?

2. When using the path where did you live? .. AS .. GYERLEAF

If at different places please provide details and years.

3. (a) How wide is the way? .. IT WAS WIDE BUT BECAME QUITE NARROW
(b) Is it the same width throughout its length? .. No

4. If you have ridden a horse on the way

- (a) Where did you keep the horse? AT HOME
(b) Where did you start and finish your ride? .. JACKSON RD - CONGLETON
(c) Were you ever riding with the hunt when you used the way? No

5. (a) When using the way did you ever see any other person driving motor or horse-drawn vehicles on the way? *YES/NO

(b) If YES, how often and what type of vehicle were they using?

(c) Have you ever driven, or been a passenger in, a motor or horse drawn vehicle on the way? *YES?NO

(d) If YES to (c),

(i) How often was this?

(ii) What type of vehicle were you in?

(iii) For what purpose was it being used?

6. (a) Has the way always been on the same route? *YES/NO

(b) If NO, please describe the original route, state when the way was diverted and show details on a plan.

(c) Is the way a clearly defined track or path which a stranger to the vicinity could follow?

(d) Have you always kept to the route of the way between the start and finish, or have you wandered from the route?

7. (a) Have there, to your knowledge, ever been any stiles on the way? *YES/NO

(b) Have there, to your knowledge, ever been any gates on the way *YES/NO

(c) If YES, please mark on the attached plan the location of the stiles or gates and state, if known, when they were erected or removed.

(d) If any gates on the way were ever locked please state, how often, and if known, by whom?

Please mark on the attached plan the locations of the locked gates.

8. (a) Excluding locked gates, have you ever known of any other obstructions to the way? *YES/NO

(b) If YES, state (i) what type of obstruction was this?

(ii) When they were erected or removed?

(c) Please state, if known, who erected the obstructions and show the approximate position of the obstructions on the attached plan.

9. Has your usage ever been hindered or prevented in any way? *YES/NO
If so by whom or what?
When was this?
Have you continued to use the way despite hindrances or obstructions *YES/NO
How did you do this? (e.g. diversion)
Is the hindrance or obstruction still in existence *YES/NO
-

10. (a) Were you ever an owner or tenant of the land crossed by the way? *YES/NO

If **YES**, please give dates.

- (b) If you were an owner or tenant did you acknowledge the route as a Public Right of Way? *YES/NO

If **YES**, please give dates.

- (c) Was the land ever owned or tenanted by a relative of yours? *YES/NO

If **so**, what was their relationship to you?

- (d) When you used the way were you working for any owner or tenant of the land adjoining or crossed by the way? *YES/NO

(e) If **YES to (d)**,

(i) What was your employment?

(ii) Between what years were you employed?

(f) If you were employed by the owner/tenant

(i) Did you receive any instructions from the owner/tenant as to the use of the way by the public? *YES/NO

(ii) If **so**, what were your instructions?

- (g) Did any relatives of yours ever work for an owner or tenant of land adjoining or crossed by the way? *YES/NO

If **so**, what was their relationship to you?

11. (a) Have you ever been stopped or turned back when using the way? *YES/NO
- (b) Do you know, or have you heard of, anyone else having been prevented from using the way? *YES/NO

(c) If YES to (a) or (b), please give details including dates.

.....

.....

-
12. (a) Were you ever told by any owner or tenant of the land crossed by the way, or by anyone in their employment, that the way was not public? *YES/NO

(b) If YES, please state:

(i) Who told you?

(ii) When you were told?

(iii) What were you told?

-
13. (a) Have you ever seen any deterrent notices such as "Private", "No Road", "No Thoroughfare" or "Trespassers will be Prosecuted", on or near the way? *YES/NO

(b) If YES, please state what the notices said appropriate date of their display and show their approximate position on the attached plan? *YES/NO

-
14. (a) Have you ever seen any notices such as "Public Path", or "footpath", or any other similar notice on or near the way? *YES/NO

(b) Have you ever seen any direction signs, finger posts or other indicators on or near the way? *YES/NO

(c) If YES to (a) or (b), please state what the notices or posts said and show their approximate position on the attached plan?

.....

15. (a) Have you ever been given permission to use the way? *YES/NO
(Whether or not you asked for it)
- (b) Have you ever asked permission to use the way? *YES/NO
- (c) If YES, who gave you permission?
- (d) When were you given permission?
- (e) For what purpose were you given permission to use the way?
-

16. (a) Have you seen other people using the way? *YES/NO
- (b) How were they using the way (ie foot, horse)?HORSE.....
- (c) Were they accompanying you? If so, please give details. (ie companions, rambling club, family, etc)?
- (d) If they were not accompanying you, were these people known to you? ...No..
- (e) How frequently did you see other people using the way? (ie daily, weekly, seasonal etc)SEASONAL.....
- (f) How many other people, approximately, did you see on these occasions? ..2..
- (g) Please give any further details of other people's use of the way which you feel may be important
-

17. Have you ever been charged a monetary sum for using the path? *YES/NO
If so, by whom?
-

18. (a) Do you have any documentary evidence about the way? *YES/NO
- (b) If so, in what form is this? ie maps, photos, etc please attach a copy if possible)
.....
- (c) Would you be willing to make the original document available if necessary? *YES/NO

N/A

19. Can you give any further information about the way (continue on a separate sheet of paper if necessary).

20. Would you be prepared to give evidence of your use of the way
at a public inquiry or in a court of law, if necessary?

*YES/~~NO~~

Please note that this form may be available to members of the public including affected owners or occupiers of the land crossed by the way.

I certify that, to the best of my knowledge and belief, the information I have given to this statement is true.

Signature: N. Nanković

Person taking this statement (if applicable)

Date: 7/9/15



CONCLETON EDGE
← (TRACTOR GRAVEYARD)

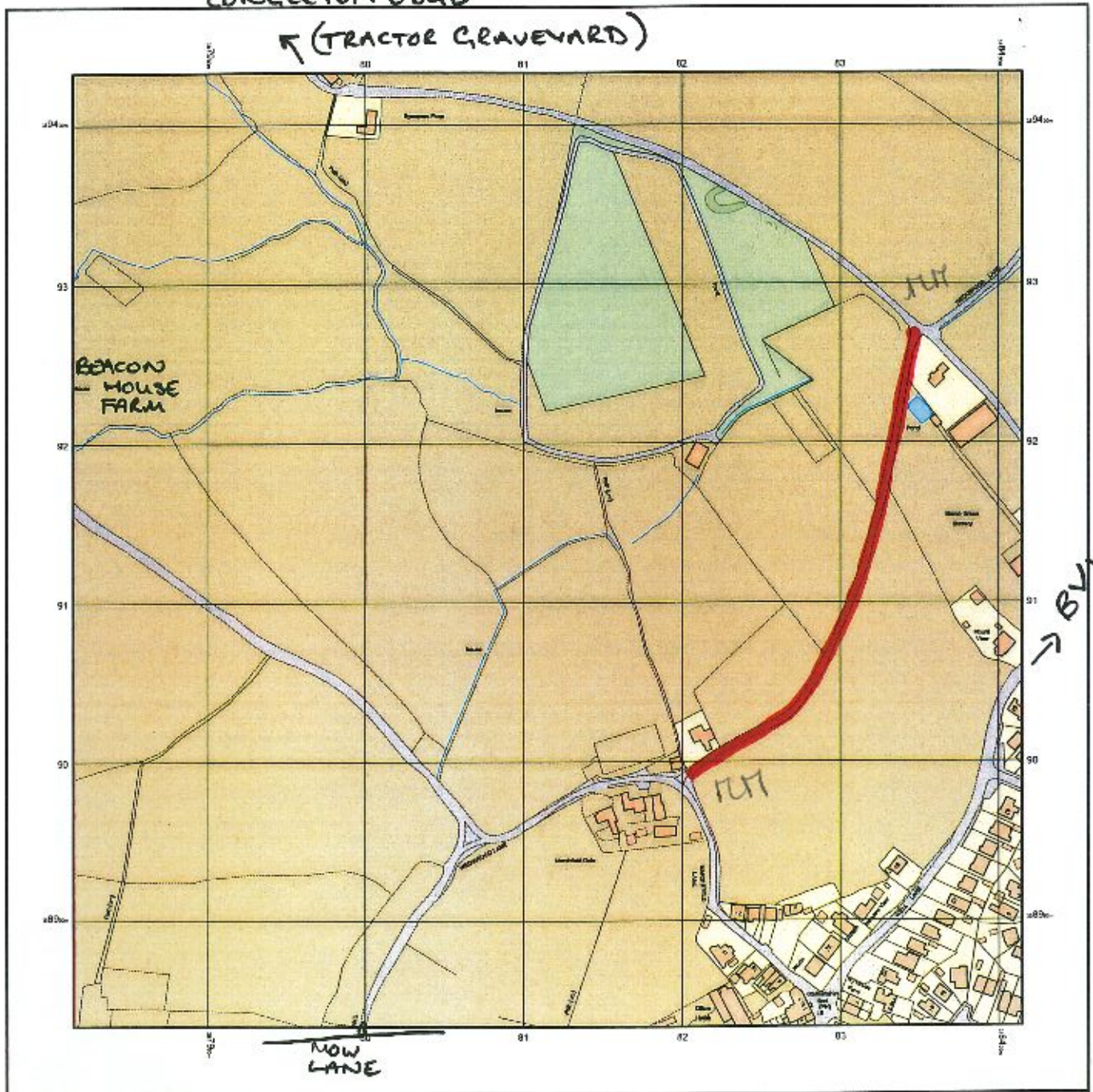

© Crown copyright and database rights 2015 Ordnance Survey 100048957. The representation of road, track or path is no evidence of a boundary or right of way. The representation of features as lines is no evidence of a property boundary.

Supplied by: www.ukmapcentre.com
Serial No: 75144
Centre Coordinates: 080115.359133
Production Date: 17/08/2015 15:06:19

THE ROUTE HIGHLIGHTED RED IS THE ROUTE I HAVE USED

SIGNED.....M. Marinkovic..... DATE.....7/9/15.....

Staffordshire

County Council

PUBLIC RIGHT OF WAY EVIDENCE FORM

Important Note

The object of this enquiry is simply to reach the truth of the matter, whatever it may be. Witnesses are therefore asked to answer the questions as fully as possible and not to keep back any information, whether for or against the public status claim. This is of particular importance if the information is to be of real value in establishing the status of the way.

Name of witness (Mr/Mrs/Miss/Ms)..... DEBIE MOODY
(Block Capitals please)

Please attach a map showing the claimed way marked in red, signed by yourself.

Guidance Notes on the completion of Public Rights of Way Evidence Forms

1. As far as possible the witness should complete the form, preferably in black ink. If another individual completes the form on their behalf they should indicate this at the end of the form.
2. Each witness should answer all questions fully with as much detail as possible.
3. Each witness should complete a separate form in respect of each claimed right of way about which she/he can give evidence.
4. A plan must be attached and the witness should clearly draw the route of the claimed right of way on the plan, and initial the plan at each end of the drawn route.
5. The route of the claimed right of way should be described as accurately as possible, if possible giving details of such things as property and field boundaries, stiles, gates, bridges and stepping stones, etc.
6. Witnesses should indicate whether they are prepared to give evidence either in a court or at a public inquiry. (The evidential value of a statement is reduced if it cannot be subject to cross examination).
7. If a witness would be unable to give evidence at a hearing because of ill health, age, etc the person obtaining the statement should endorse the form accordingly, and be able to give evidence of the circumstances.
8. The information given on this form may become available for public inspection.

Description of claimed way:- (include grid references if known)
From

To

Please take time to answer the questions carefully and in full

1. (a) How many years have you known the way? 20 YEARS
(b) Does the way have a popular name?
(c) Have you personally used the above way? *YES/NO
(d) Did you only use part of the way? *YES/NO

Please do not use vague terms such as "often".

- (e) During which years have you used the way? From... 1995 ... To ... 2015
(f) Where were you going from/to? PUBLIC BRIDLEWAY 79 to MARSHFIELD RD
(g) For what purpose? (eg work, pleasure) PLEASURE
(h) How many times a year? (eg daily, weekly, seasonal) WEEKLY
(i) By what means? (eg on foot, horseback, motor vehicle etc) HORSE BACK
(j) Is, or was, the way a short cut for you? NO
(k) If so why?

(l) Please show on the attached plan the route of the way you have used.
If you have only used part of the way please mark or indicate the part used.

- (m) Do you still use the way? YES
(n) If not why not?

2. When using the path where did you live? 19 DAVES ROAD CONINGTON CV312 3RA

If at different places please provide details and years.

3. (a) How wide is the way? 6ft approx
(b) Is it the same width throughout its length? No

4. If you have ridden a horse on the way
(a) Where did you keep the horse? NEW COP RIDING SCHOOL
OWN HORSE LIVERY CONINGTON
(b) Where did you start and finish your ride? AS ABOVE
(c) Were you ever riding with the hunt when you used the way? No

5. (a) When using the way did you ever see any other person driving motor or horse-drawn vehicles on the way? *~~YES~~/NO
- (b) If **YES**, how often and what type of vehicle were they using?
- (c) Have you ever driven, or been a passenger in, a motor or horse drawn vehicle on the way? *~~YES~~?NO
- (d) If **YES** to (c),
- (i) How often was this?
- (ii) What type of vehicle were you in?
- (iii) For what purpose was it being used?
-

6. (a) Has the way always been on the same route? *~~YES~~/NO
- (b) If **NO**, please describe the original route, state when the way was diverted and show details on a plan.
- (c) Is the way a clearly defined track or path which a stranger to the vicinity could follow? ...YES.....
- (d) Have you always kept to the route of the way between the start and finish, or have you wandered from the route? KEPT TO ROUTE.....
-

7. (a) Have there, to your knowledge, ever been any stiles on the way? *~~YES~~/NO
- (b) Have there, to your knowledge, ever been any gates on the way *~~YES~~/NO
- (c) If **YES**, please mark on the attached plan the location of the stiles or gates and state, if known, when they were erected or removed.
- (d) If any gates on the way were ever locked please state, how often, and if known, by whom?
- Please mark on the attached plan the locations of the locked gates.
-

8. (a) Excluding locked gates, have you ever known of any other obstructions to the way? *~~YES~~/NO
- (b) If **YES**, state (i) what type of obstruction was this?
- (ii) When they were erected or removed?
- (c) Please state, if known, who erected the obstructions and show the approximate position of the obstructions on the attached plan.

9. Has your usage ever been hindered or prevented in any way? ~~YES~~/NO

If so by whom or what?

When was this?

Have you continued to use the way despite hindrances or obstructions *YES/NO

How did you do this? (e.g. diversion)

Is the hindrance or obstruction still in existence *YES/NO

10. (a) Were you ever an owner or tenant of the land crossed by the way? ~~YES~~/NO

If YES, please give dates.

(b) If you were an owner or tenant did you acknowledge the route as a Public Right of Way? *YES/NO

If YES, please give dates.

(c) Was the land ever owned or tenanted by a relative of yours? ~~YES~~/NO

If so, what was their relationship to you?

(d) When you used the way were you working for any owner or tenant of the land adjoining or crossed by the way? ~~YES~~/NO

(e) If YES to (d),

(i) What was your employment?

(ii) Between what years were you employed?

(f) If you were employed by the owner/tenant

(i) Did you receive any instructions from the owner/tenant as to the use of the way by the public? *YES/NO

(ii) If so, what were your instructions?

(g) Did any relatives of yours ever work for an owner or tenant of land adjoining or crossed by the way? *YES/NO

If so, what was their relationship to you?

11. (a) Have you ever been stopped or turned back when using the way? *~~YES~~/NO

(b) Do you know, or have you heard of, anyone else having been prevented from using the way? *~~YES~~/NO

(c) If **YES** to (a) or (b), please give details including dates.

.....
.....

12. (a) Were you ever told by any owner or tenant of the land crossed by the way, or by anyone in their employment, that the way was not public? *~~YES~~/NO

(b) If **YES**, please state:

(i) Who told you?

(ii) When you were told?

(iii) What were you told?

13. (a) Have you ever seen any deterrent notices such as "Private", "No Road", "No Thoroughfare" or "Trespassers will be Prosecuted", on or near the way? *~~YES~~/NO

(b) If **YES**, please state what the notices said appropriate date of their display and show their approximate position on the attached plan? *~~YES~~/NO

14. (a) Have you ever seen any notices such as "Public Path", or "footpath", or any other similar notice on or near the way? *~~YES~~/NO

(b) Have you ever seen any direction signs, finger posts or other indicators on or near the way? *~~YES~~/NO

(c) If **YES** to (a) or (b), please state what the notices or posts said and show their approximate position on the attached plan?

.....

15. (a) Have you ever been given permission to use the way? ~~YES~~/NO
(Whether or not you asked for it)
- (b) Have you ever asked permission to use the way? ~~YES~~/NO
- (c) If YES, who gave you permission?
- (d) When were you given permission?
- (e) For what purpose were you given permission to use the way?
-

16. (a) Have you seen other people using the way? *YES/~~NO~~
- (b) How were they using the way (ie foot, horse)? HORSE.....
- (c) Were they accompanying you? If so, please give details. (ie companions, rambling club, family, etc)? FRIENDS
- (d) If they were not accompanying you, were these people known to you? ...NO..
- (e) How frequently did you see other people using the way? (ie daily, weekly, seasonal etc) ONCE A MONTH, SOME MONTHS MORE
- (f) How many other people, approximately, did you see on these occasions? ...3
- (g) Please give any further details of other people's use of the way which you feel may be important TENDED TO BE OTHER PEOPLE ON HORSES
-

17. Have you ever been charged a monetary sum for using the path? *YES/NO
If so, by whom?
-

18. (a) Do you have any documentary evidence about the way? *YES/NO
- (b) If so, in what form is this? ie maps, photos, etc please attach a copy if possible)
.....
- (c) Would you be willing to make the original document available if necessary? *YES/NO O/A

19. Can you give any further information about the way (continue on a separate sheet of paper if necessary).

20. Would you be prepared to give evidence of your use of the way
at a public inquiry or in a court of law, if necessary?

YES/NO

Please note that this form may be available to members of the public including affected owners or occupiers of the land crossed by the way.

I certify that, to the best of my knowledge and belief, the information I have given to this statement is true.

Signature: D. Stacey

Person taking this statement (if applicable)

Date: 25/8/15

CONCLETON EDGE

(TRACTOR GRAVEYARD)

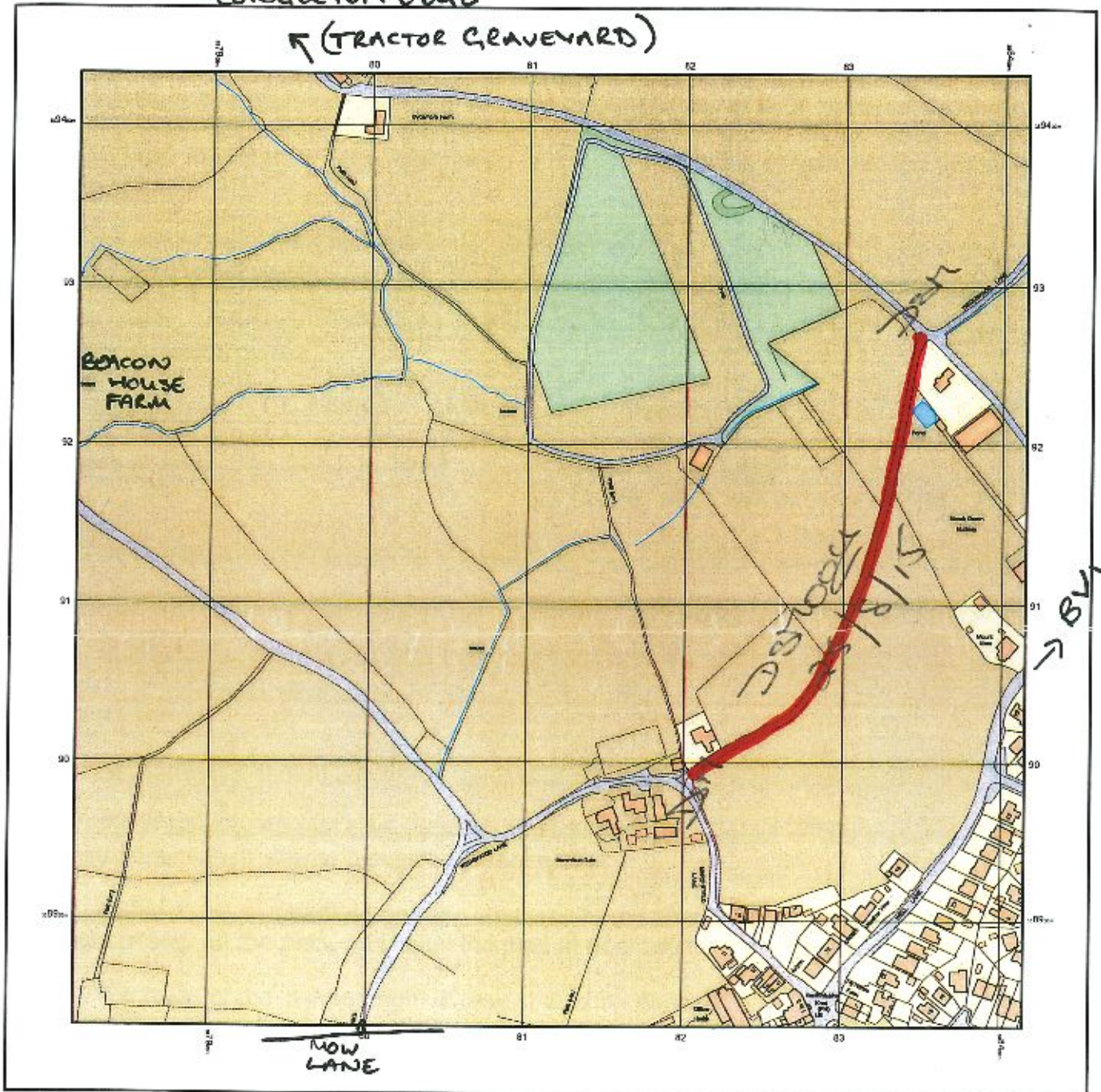

© Crown copyright and database rights 2015 Ordnance Survey 100049967. The representation of road, track or path is no evidence of a boundary or right of way. The representation of features as lines is no evidence of a property boundary.

Supplied by: www.ukmapcentre.com
 Serial No: 76144
 Centre Coordinates: 388116.389133
 Production Date: 17/08/2015 15:05:19

THE ROUTE HIGHLIGHTED RED IS THE ROUTE I HAVE USED

SIGNED..... DATE.....

Staffordshire

County Council

PUBLIC RIGHT OF WAY EVIDENCE FORM

Important Note

The object of this enquiry is simply to reach the truth of the matter, whatever it may be. Witnesses are therefore asked to answer the questions as fully as possible and not to keep back any information, whether for or against the public status claim. This is of particular importance if the information is to be of real value in establishing the status of the way.

Name of witness (Mr/Mrs/Miss/Ms).....ALEXANDRA.....MEAKIN.....
(Print name clearly)

Please attach a map showing the claimed way marked in red, signed by yourself.

Guidance Notes on the completion of Public Rights of Way Evidence Forms

1. As far as possible the witness should complete the form, preferably in black ink. If another individual completes the form on their behalf they should indicate this at the end of the form.
2. Each witness should answer all questions fully with as much detail as possible.
3. Each witness should complete a separate form in respect of each claimed right of way about which she/he can give evidence.
4. A plan must be attached and the witness should clearly draw the route of the claimed right of way on the plan, and initial the plan at each end of the drawn route.
5. The route of the claimed right of way should be described as accurately as possible, if possible giving details of such things as property and field boundaries, stiles, gates, bridges and stepping stones, etc.
6. Witnesses should indicate whether they are prepared to give evidence either in a court or at a public inquiry. (The evidential value of a statement is reduced if it cannot be subject to cross examination).
7. If a witness would be unable to give evidence at a hearing because of ill health, age, etc the person obtaining the statement should endorse the form accordingly, and be able to give evidence of the circumstances.
8. The information given on this form may become available for public inspection.

Description of claimed way:- (include grid references if known)

From

To

Please take time to answer the questions carefully and in full

1. (a) How many years have you known the way? ~~25~~ 18.....
(b) Does the way have a popular name?
(c) Have you personally used the above way? YES/NO
(d) Did you only use part of the way? *YES/NO

Please do not use vague terms such as "often".

- (e) During which years have you used the way? From 1997 To PRESENT.....
(f) Where were you going from/to? MARSHFIELD LANE TO WELLS LANE
(g) For what purpose? (eg work, pleasure) PLEASURE - HORSE RIDING
(h) How many times a year? (eg daily, weekly, seasonal) AT LEAST BI-MONTHLY
(i) By what means? (eg on foot, horseback, motor vehicle etc) HORSEBACK
(j) Is, or was, the way a short cut for you? NO
(k) If so why? IT IS PREFERABLE ROUTE AS IT IS OFF ROAD SO LESS DISRUPTION TO TRAFFIC

(l) Please show on the attached plan the route of the way you have used.

If you have only used part of the way please mark or indicate the part used.

- (m) Do you still use the way? YES WHEN IT IS POSSIBLE
(n) If not why not? WHEN OVERCROWN IN SPRING IT IS TOO OVERCROWN TO USE

2. When using the path where did you live? CONGLETON # THEN BIDDULPH

If at different places please provide details and years.

LIVED IN CONGLETON UNTIL JUNE 97 THEN MOVED TO BIDDULPH

3. (a) How wide is the way? NARROW - HORSE WIDTH

- (b) Is it the same width throughout its length? NO IT IS NARROWER IN PLACES

4. If you have ridden a horse on the way

(a) Where did you keep the horse? BIDDULPH FROM 2011 CONGLETON PREVIOUSLY

(b) Where did you start and finish your ride? GILLON HEATH MORE RECENTLY

(c) Were you ever riding with the hunt when you used the way? NO

5. (a) When using the way did you ever see any other person driving motor or horse-drawn vehicles on the way? *YES/NO

(b) If YES, how often and what type of vehicle were they using?

(c) Have you ever driven, or been a passenger in, a motor or horse drawn vehicle on the way? *YES/NO

(d) If YES to (c),

(i) How often was this?

(ii) What type of vehicle were you in?

(iii) For what purpose was it being used?

6. (a) Has the way always been on the same route? YES/NO

(b) If NO, please describe the original route, state when the way was diverted and show details on a plan.

(c) Is the way a clearly defined track or path which a stranger to the vicinity could follow? Yes

(d) Have you always kept to the route of the way between the start and finish, or have you wandered from the route? STUCK TO ROUTE

7. (a) Have there, to your knowledge, ever been any stiles on the way? *YES/NO

(b) Have there, to your knowledge, ever been any gates on the way? *YES/NO

(c) If YES, please mark on the attached plan the location of the stiles or gates and state, if known, when they were erected or removed.

(d) If any gates on the way were ever locked please state, how often, and if known, by whom?

Please mark on the attached plan the locations of the locked gates.

8. (a) Excluding locked gates, have you ever known of any other obstructions to the way? YES/NO

(b) If YES, state (i) what type of obstruction was this? OVERCROWN HEDGES

(ii) When they were erected or removed? OCCASIONALLY CUT BACK

(c) Please state, if known, who erected the obstructions and show the approximate position of the obstructions on the attached plan.

9. Has your usage ever been hindered or prevented in any way? *YES/NO

If so by whom or what? OVERGROWN TREES

When was this? EVERY SPRING

Have you continued to use the way despite hindrances or obstructions *YES/NO

How did you do this? (e.g. diversion)

Is the hindrance or obstruction still in existence *YES/NO

10. (a) Were you ever an owner or tenant of the land crossed by the way? *YES/NO

If YES, please give dates.

(b) If you were an owner or tenant did you acknowledge the route as a Public Right of Way? *YES/NO

If YES, please give dates.

(c) Was the land ever owned or tenanted by a relative of yours? *YES/NO

If so, what was their relationship to you?

(d) When you used the way were you working for any owner or tenant of the land adjoining or crossed by the way? *YES/NO

(e) **If YES to (d)**,

(i) What was your employment?

(ii) Between what years were you employed?

(f) If you were employed by the owner/tenant

(i) Did you receive any instructions from the owner/tenant as to the use of the way by the public? *YES/NO

(ii) **If so**, what were your instructions?

(g) Did any relatives of yours ever work for an owner or tenant of land adjoining or crossed by the way? *YES/NO

If so, what was their relationship to you?

11. (a) Have you ever been stopped or turned back when using the way? *YES/NO YES NO

(b) Do you know, or have you heard of, anyone else having been prevented from using the way? *YES/NO YES NO

(c) If YES to (a) or (b), please give details including dates.

.....
.....

12. (a) Were you ever told by any owner or tenant of the land crossed by the way, or by anyone in their employment, that the way was not public? *YES/NO YES NO

(b) If YES, please state:

(i) Who told you?

(ii) When you were told?

(iii) What were you told?

13. (a) Have you ever seen any deterrent notices such as "Private", "No Road", "No Thoroughfare" or "Trespassers will be Prosecuted", on or near the way? *YES/NO YES NO

(b) If YES, please state what the notices said appropriate date of their display and show their approximate position on the attached plan? *YES/NO

14. (a) Have you ever seen any notices such as "Public Path", or "footpath", or any other similar notice on or near the way? YES NO

(b) Have you ever seen any direction signs, finger posts or other indicators on or near the way? YES NO

(c) If YES to (a) or (b), please state what the notices or posts said and show their approximate position on the attached plan? FOOTPATH SIGN

ON ADJACENT PATH BETWEEN WOODGROVE LANE + WELL LANE. PATH UNACCESSIBLE BY HORSES

15. (a) Have you ever been given permission to use the way?
(Whether or not you asked for it) *YES/NO
- (b) Have you ever asked permission to use the way? *YES/NO
- (c) If YES, who gave you permission?
- (d) When were you given permission?
- (e) For what purpose were you given permission to use the way?
-

16. (a) Have you seen other people using the way? *YES/NO
- (b) How were they using the way (ie foot, horse)? ...HORSE + FOOT.....
- (c) Were they accompanying you? If so, please give details. (ie companions, rambling club, family, etc)?NO.....
- (d) If they were not accompanying you, were these people known to you?NO.....
- (e) How frequently did you see other people using the way? (ie daily, weekly, seasonal etc) ...REGULARLY... IN ...SUMMER / AUTUMN... WHEN POSSIBLE.....
- (f) How many other people, approximately, did you see on these occasions? ..2.....
- (g) Please give any further details of other people's use of the way which you feel may be important
-

17. Have you ever been charged a monetary sum for using the path?
If so, by whom? *YES/NO
-

18. (a) Do you have any documentary evidence about the way? *YES/NO
- (b) If so, in what form is this? ie maps, photos, etc please attach a copy if possible)
.....
- (c) Would you be willing to make the original document available if necessary? *YES/NO

19. Can you give any further information about the way (continue on a separate sheet of paper if necessary).

20. Would you be prepared to give evidence of your use of the way at a public inquiry or in a court of law, if necessary?

YES/ NO

Please note that this form may be available to members of the public including affected owners or occupiers of the land crossed by the way.

I certify that, to the best of my knowledge and belief, the information I have given to this statement is true.

Signature: 

Person taking this statement (if applicable)

Date: 28-8-15

CONCLETON EDGE
← (TRACTOR GRAVEYARD)

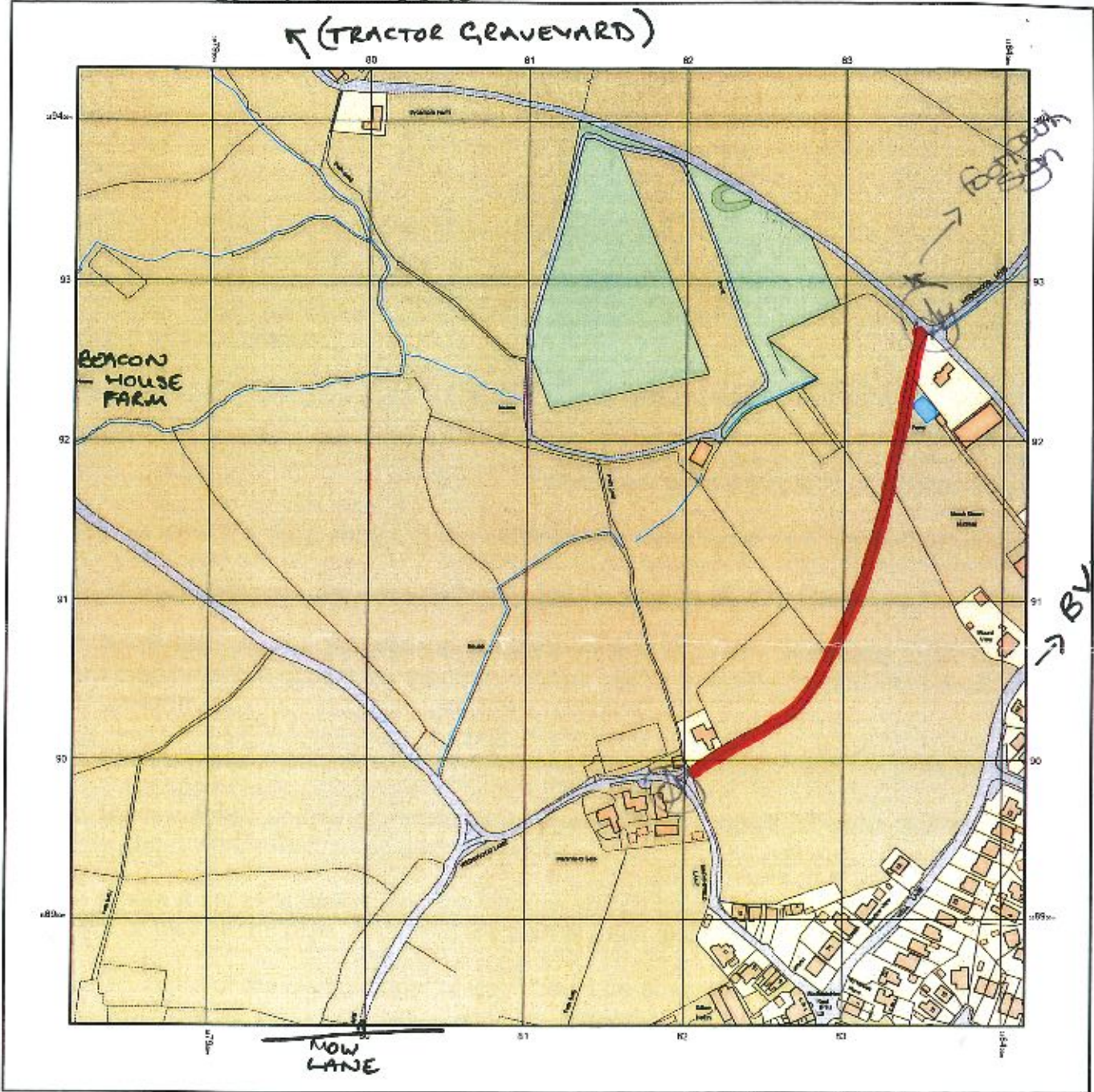

© Crown copyright and database rights 2015 Ordnance Survey 100048957. The representation of road, track or path is no evidence of a boundary or right of way. The representation of features as lines is no evidence of a property boundary.

Supplied by: www.ukmapcentre.com
Serial No. 78144
Centre Coordinates: 388115, 359133
Production Date: 17/08/2015 15:05:18

THE ROUTE HIGHLIGHTED RED IS THE ROUTE I HAVE USED

SIGNED *[Signature]* DATE 27-8-15

Staffordshire

County Council

PUBLIC RIGHT OF WAY EVIDENCE FORM

Important Note

The object of this enquiry is simply to reach the truth of the matter, whatever it may be. Witnesses are therefore asked to answer the questions as fully as possible and not to keep back any information, whether for or against the public status claim. This is of particular importance if the information is to be of real value in establishing the status of the way.

Name of witness (Mr/Mrs/Miss/Ms) MARJORY HIGGS
(Block Capitals please)

Please attach a map showing the claimed way marked in red, signed by yourself.

Guidance Notes on the completion of Public Rights of Way Evidence Forms

1. As far as possible the witness should complete the form, preferably in black ink. If another individual completes the form on their behalf they should indicate this at the end of the form.
2. Each witness should answer all questions fully with as much detail as possible.
3. Each witness should complete a separate form in respect of each claimed right of way about which she/he can give evidence.
4. A plan must be attached and the witness should clearly draw the route of the claimed right of way on the plan, and initial the plan at each end of the drawn route.
5. The route of the claimed right of way should be described as accurately as possible, if possible giving details of such things as property and field boundaries, stiles, gates, bridges and stepping stones, etc.
6. Witnesses should indicate whether they are prepared to give evidence either in a court or at a public inquiry. (The evidential value of a statement is reduced if it cannot be subject to cross examination).
7. If a witness would be unable to give evidence at a hearing because of ill health, age, etc the person obtaining the statement should endorse the form accordingly, and be able to give evidence of the circumstances.
8. The information given on this form may become available for public inspection.

Description of claimed way:- (include grid references if known)

From

To

Please take time to answer the questions carefully and in full

1. (a) How many years have you known the way? 16 years
(b) Does the way have a popular name? WEDGWOOD LANE
(c) Have you personally used the above way? *YES/NO
(d) Did you only use part of the way? *YES/NO

Please do not use vague terms such as "often".

- (e) During which years have you used the way? From 1999 To 2001
(f) Where were you going from/to? 3hr back from BUTTERLANDS RIDING SCHOOL
(g) For what purpose? (eg work, pleasure) pleasure
(h) How many times a year? (eg daily, weekly, seasonal) BANK HOLIDAYS
(i) By what means? (eg on foot, horseback, motor vehicle etc) HORSEBACK
(j) Is, or was, the way a short cut for you? NO
(k) If so why?
..... + ENDURANCE RIDES 2011 - 2012 - 2014

(l) Please show on the attached plan the route of the way you have used.
If you have only used part of the way please mark or indicate the part used.

- (m) Do you still use the way? YES
(n) If not why not?

2. When using the path where did you live? MALLESFIELD

If at different places please provide details and years.

3. (a) How wide is the way?
(b) Is it the same width throughout its length?

4. If you have ridden a horse on the way
(a) Where did you keep the horse? BUTTERLANDS, GAWSWORTH MY HORSE
(b) Where did you start and finish your ride? CONGLETON
(c) Were you ever riding with the hunt when you used the way? NO

5. (a) When using the way did you ever see any other person driving motor or horse-drawn vehicles on the way? *YES/NO

(b) If YES, how often and what type of vehicle were they using?

(c) Have you ever driven, or been a passenger in, a motor or horse drawn vehicle on the way? *YES?NO

(d) If YES to (c),

(i) How often was this?

(ii) What type of vehicle were you in?

(iii) For what purpose was it being used?

6. (a) Has the way always been on the same route? *YES/NO

(b) If NO, please describe the original route, state when the way was diverted and show details on a plan.

(c) Is the way a clearly defined track or path which a stranger to the vicinity could follow?

(d) Have you always kept to the route of the way between the start and finish, or have you wandered from the route?

7. (a) Have there, to your knowledge, ever been any stiles on the way? *YES/NO

(b) Have there, to your knowledge, ever been any gates on the way *YES/NO

(c) If YES, please mark on the attached plan the location of the stiles or gates and state, if known, when they were erected or removed.

(d) If any gates on the way were ever locked please state, how often, and if known, by whom?

Please mark on the attached plan the locations of the locked gates.

8. (a) Excluding locked gates, have you ever known of any other obstructions to the way? *YES/NO

(b) If YES, state (i) what type of obstruction was this?

(ii) When they were erected or removed?

(c) Please state, if known, who erected the obstructions and show the approximate position of the obstructions on the attached plan.

9. Has your usage ever been hindered or prevented in any way? *YES/NO
 If so by whom or what?
 When was this?
 Have you continued to use the way despite hindrances or obstructions *YES/NO
 How did you do this? (e.g. diversion)
 Is the hindrance or obstruction still in existence *YES/NO

10. (a) Were you ever an owner or tenant of the land crossed by the way? *YES/NO
 If YES, please give dates.
 (b) If you were an owner or tenant did you acknowledge the route as a Public Right of Way? *YES/NO
 If YES, please give dates.
 (c) Was the land ever owned or tenanted by a relative of yours? *YES/NO
 If so, what was their relationship to you?
 (d) When you used the way were you working for any owner or tenant of the land adjoining or crossed by the way? *YES/NO
 (e) If YES to (d),
 (i) What was your employment?
 (ii) Between what years were you employed?
 (f) If you were employed by the owner/tenant
 (i) Did you receive any instructions from the owner/tenant as to the use of the way by the public? *YES/NO
 (ii) If so, what were your instructions?
 (g) Did any relatives of yours ever work for an owner or tenant of land adjoining or crossed by the way? *YES/NO
 If so, what was their relationship to you?

11. (a) Have you ever been stopped or turned back when using the way? *YES/NO

(b) Do you know, or have you heard of, anyone else having been prevented from using the way? *YES/NO

(c) If YES to (a) or (b), please give details including dates.

.....
.....

12. (a) Were you ever told by any owner or tenant of the land crossed by the way, or by anyone in their employment, that the way was not public? *YES/NO

(b) If YES, please state:

(i) Who told you?

(ii) When you were told?

(iii) What were you told?

13. (a) Have you ever seen any deterrent notices such as "Private", "No Road", "No Thoroughfare" or "Trespassers will be Prosecuted", on or near the way? *YES/NO

(b) If YES, please state what the notices said appropriate date of their display and show their approximate position on the attached plan? *YES/NO

14. (a) Have you ever seen any notices such as "Public Path", or "footpath", or any other similar notice on or near the way? *YES/NO

(b) Have you ever seen any direction signs, finger posts or other indicators on or near the way? *YES/NO

(c) If YES to (a) or (b), please state what the notices or posts said and show their approximate position on the attached plan?

.....

15. (a) Have you ever been given permission to use the way?
(Whether or not you asked for it) *YES/NO
- (b) Have you ever asked permission to use the way? *YES/NO
- (c) If YES, who gave you permission?
- (d) When were you given permission?
- (e) For what purpose were you given permission to use the way?
-

16. (a) Have you seen other people using the way? *YES/NO
- (b) How were they using the way (ie foot, horse)?HORSE.....
- (c) Were they accompanying you? If so, please give details. (ie companions, rambling club, family, etc)?ENDURANCE RIDE.....
- (d) If they were not accompanying you, were these people known to you?
- (e) How frequently did you see other people using the way? (ie daily, weekly, seasonal etc)yearly.....
- (f) How many other people, approximately, did you see on these occasions?
- (g) Please give any further details of other people's use of the way which you feel may be important
-

17. Have you ever been charged a monetary sum for using the path? *YES/NO
If so, by whom?
-

18. (a) Do you have any documentary evidence about the way? *YES/NO
- (b) If so, in what form is this? ie maps, photos, etc please attach a copy if possible)
.....
- (c) Would you be willing to make the original document available if necessary? *YES/NO

19. Can you give any further information about the way (continue on a separate sheet of paper if necessary).

20. Would you be prepared to give evidence of your use of the way
at a public inquiry or in a court of law, if necessary?

*YES/NO

Please note that this form may be available to members of the public including affected owners or occupiers of the land crossed by the way.

I certify that, to the best of my knowledge and belief, the information I have given to this statement is true.

Signature: *Margery Higgs*.....

Person taking this statement (if applicable)

Date:

CONCLETON EDGE
← (TRACTOR GRAVEYARD)

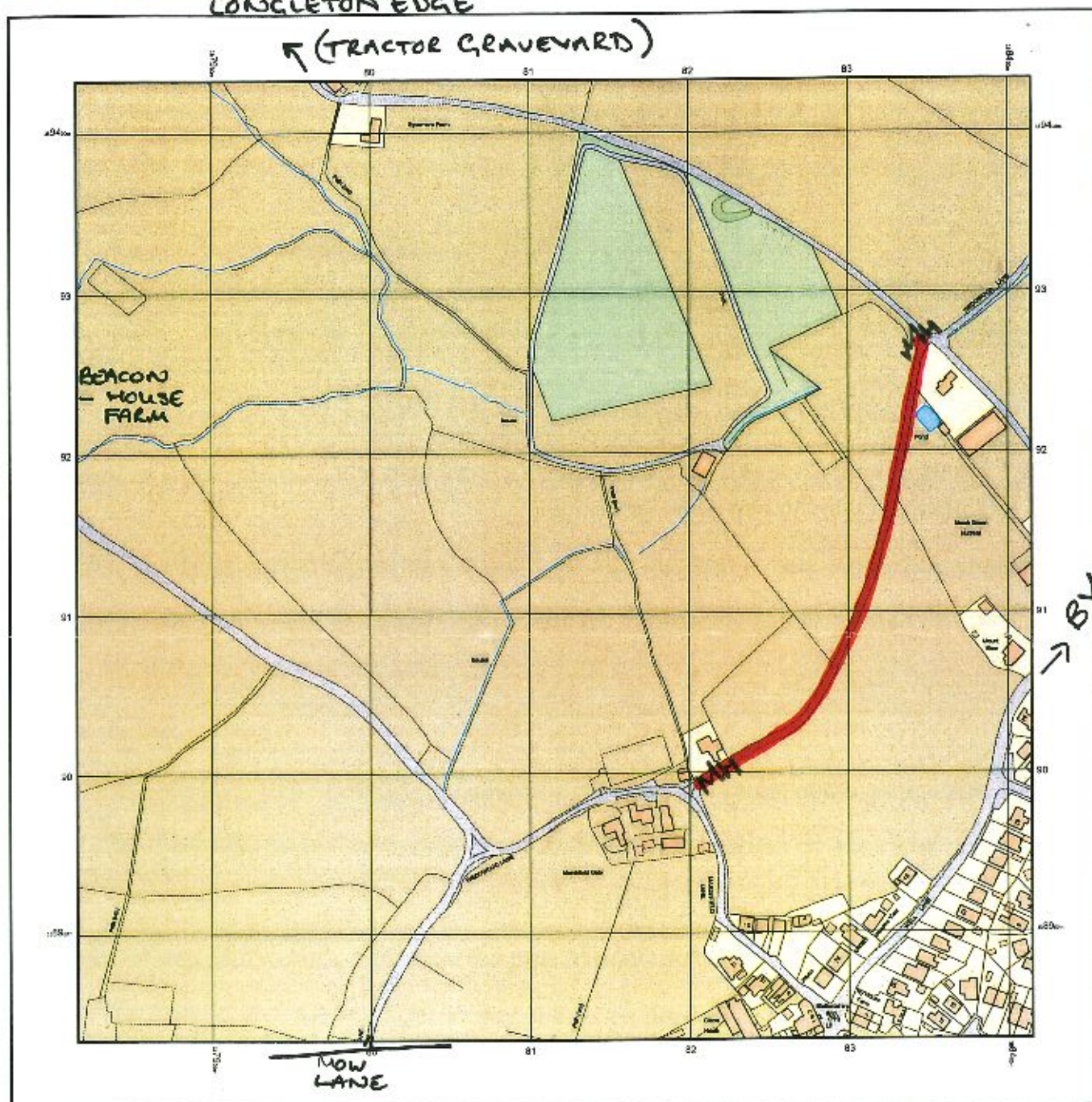

© Crown Copyright and database rights 2015 Ordnance Survey 100043857. The representation of road, track or path is no evidence of a boundary or right of way. The representation of features as lines is no evidence of a property boundary.

Supplied by: www.ukmapcentre.com
Serial No: 76144
Centre Coordinates: 388115, 359133
Production Date: 17/08/2015 16:08:19

THE ROUTE HIGHLIGHTED RED IS THE ROUTE I HAVE USED

SIGNED Marjory Higgs DATE 9-9-2015

Staffordshire

County Council

PUBLIC RIGHT OF WAY EVIDENCE FORM **Important Note**

The object of this enquiry is simply to reach the truth of the matter, whatever it may be. Witnesses are therefore asked to answer the questions as fully as possible and not to keep back any information, whether for or against the public status claim. This is of particular importance if the information is to be of real value in establishing the status of the way.

Name of witness (Mr/Mrs/Miss/Ms)..... MRS PAT QUERIN.....
(Block Capital please)

Please attach a map showing the claimed way marked in red, signed by yourself.

Guidance Notes on the completion of Public Rights of Way Evidence Forms

1. As far as possible the witness should complete the form, preferably in black ink. If another individual completes the form on their behalf they should indicate this at the end of the form.
2. Each witness should answer all questions fully with as much detail as possible.
3. Each witness should complete a separate form in respect of each claimed right of way about which she/he can give evidence.
4. A plan must be attached and the witness should clearly draw the route of the claimed right of way on the plan, and initial the plan at each end of the drawn route.
5. The route of the claimed right of way should be described as accurately as possible, if possible giving details of such things as property and field boundaries, stiles, gates, bridges and stepping stones, etc.
6. Witnesses should indicate whether they are prepared to give evidence either in a court or at a public inquiry. (The evidential value of a statement is reduced if it cannot be subject to cross examination).
7. If a witness would be unable to give evidence at a hearing because of ill health, age, etc the person obtaining the statement should endorse the form accordingly, and be able to give evidence of the circumstances.
8. The information given on this form may become available for public inspection.

Description of claimed way:- (include grid references if known)

From

To

Please take time to answer the questions carefully and in full

1. (a) How many years have you known the way? 15
(b) Does the way have a popular name? I DO NOT KNOW
(c) Have you personally used the above way? *YES/ *YES/NO
(d) Did you only use part of the way? *YES/ *YES/NO

Please do not use vague terms such as "often".

- (e) During which years have you used the way? From 2000 To 2015
(f) Where were you going from/to? TIMBERSBROOK → TIMBERSBROOK
(g) For what purpose? (eg work, pleasure) PLEASURE
(h) How many times a year? (eg daily, weekly, seasonal) SEASONAL
(i) By what means? (eg on foot, horseback, motor vehicle etc) HORSEBACK
(j) Is, or was, the way a short cut for you? NO. AN OFF-ROAD ROUTE
(k) If so why?

(l) Please show on the attached plan the route of the way you have used.
If you have only used part of the way please mark or indicate the part used.

- (m) Do you still use the way? YES
(n) If not why not?

2. When using the path where did you live? ALLOSTOCK

If at different places please provide details and years.

3. (a) How wide is the way? VARIABLE - OVERGROWN IN PLACES

(b) Is it the same width throughout its length? NOT THE LAST TUNE I RODE IT

4. If you have ridden a horse on the way
(a) Where did you keep the horse? ALLOSTOCK

(b) Where did you start and finish your ride? TIMBERSBROOK CAR PARK

(c) Were you ever riding with the hunt when you used the way? NO

5. (a) When using the way did you ever see any other person driving motor or horse-drawn vehicles on the way? ~~YES~~/NO

(b) If YES, how often and what type of vehicle were they using?

(c) Have you ever driven, or been a passenger in, a motor or horse drawn vehicle on the way? ~~YES~~?NO

(d) If YES to (c),

(i) How often was this?

(ii) What type of vehicle were you in?

(iii) For what purpose was it being used?

6. (a) Has the way always been on the same route? *YES/~~NO~~

(b) If NO, please describe the original route, state when the way was diverted and show details on a plan.

(c) Is the way a clearly defined track or path which a stranger to the vicinity could follow? YES.....

(d) Have you always kept to the route of the way between the start and finish, or have you wandered from the route? KEPT TO THE ROUTE.....

7. (a) Have there, to your knowledge, ever been any stiles on the way? ~~YES~~/NO

(b) Have there, to your knowledge, ever been any gates on the way? ~~YES~~/NO

(c) If YES, please mark on the attached plan the location of the stiles or gates and state, if known, when they were erected or removed.

(d) If any gates on the way were ever locked please state, how often, and if known, by whom?

Please mark on the attached plan the locations of the locked gates.

8. (a) Excluding locked gates, have you ever known of any other obstructions to the way? ~~YES~~/NO

(b) If YES, state (i) what type of obstruction was this?

(ii) When they were erected or removed?

(c) Please state, if known, who erected the obstructions and show the approximate position of the obstructions on the attached plan.

9. Has your usage ever been hindered or prevented in any way? *~~YES~~/NO

If so by whom or what?

When was this?

Have you continued to use the way despite hindrances or obstructions *YES/NO

How did you do this? (e.g. diversion)

Is the hindrance or obstruction still in existence *YES/NO

10. (a) Were you ever an owner or tenant of the land crossed by the way? *~~YES~~/NO

If YES, please give dates.

(b) If you were an owner or tenant did you acknowledge the route as a Public Right of Way? *YES/NO

If YES, please give dates.

(c) Was the land ever owned or tenanted by a relative of yours? *~~YES~~/NO

If so, what was their relationship to you?

(d) When you used the way were you working for any owner or tenant of the land adjoining or crossed by the way? *~~YES~~/NO

(e) If YES to (d),

(i) What was your employment?

(ii) Between what years were you employed?

(f) If you were employed by the owner/tenant

(i) Did you receive any instructions from the owner/tenant as to the use of the way by the public? *YES/NO

(ii) If so, what were your instructions?

(g) Did any relatives of yours ever work for an owner or tenant of land adjoining or crossed by the way? *YES/NO

If so, what was their relationship to you?

11. (a) Have you ever been stopped or turned back when using the way? ~~YES~~/NO

(b) Do you know, or have you heard of, anyone else having been prevented from using the way? *YES/NO

(c) If YES to (a) or (b), please give details including dates.

.....
.....

12. (a) Were you ever told by any owner or tenant of the land crossed by the way, or by anyone in their employment, that the way was not public? *YES/NO

(b) If YES, please state:

(i) Who told you?

(ii) When you were told?

(iii) What were you told?

13. (a) Have you ever seen any deterrent notices such as "Private", "No Road", "No Thoroughfare" or "Trespassers will be Prosecuted", on or near the way? ~~YES~~/NO

(b) If YES, please state what the notices said appropriate date of their display and show their approximate position on the attached plan? *YES/NO

14. (a) Have you ever seen any notices such as "Public Path", or "footpath", or any other similar notice on or near the way? *YES/NO

(b) Have you ever seen any direction signs, finger posts or other indicators on or near the way? *YES/NO

(c) If YES to (a) or (b), please state what the notices or posts said and show their approximate position on the attached plan?

.....

15. (a) Have you ever been given permission to use the way?
(Whether or not you asked for it) *~~YES~~/NO
- (b) Have you ever asked permission to use the way? *~~YES~~/NO
- (c) If **YES**, who gave you permission?
- (d) When were you given permission?
- (e) For what purpose were you given permission to use the way?
-

16. (a) Have you seen other people using the way? *YES/~~NO~~
- (b) How were they using the way (ie foot, horse)? HORSE..... FOOT.....
- (c) Were they accompanying you? If so, please give details. (ie companions, rambling club, family, etc)? RIDING COMPANIONS, WALKERS
- (d) If they were not accompanying you, were these people known to you? ...NO....
- (e) How frequently did you see other people using the way? (ie daily, weekly, seasonal etc) SEASONAL.....
- (f) How many other people, approximately, did you see on these occasions? 1-2
- (g) Please give any further details of other people's use of the way which you feel may be important
-

17. Have you ever been charged a monetary sum for using the path?
If so, by whom? *~~YES~~/NO
-

18. (a) Do you have any documentary evidence about the way? *~~YES~~/NO
- (b) If so, in what form is this? ie maps, photos, etc please attach a copy if possible)
-
- (c) Would you be willing to make the original document available if necessary? *YES/NO

19. Can you give any further information about the way (continue on a separate sheet of paper if necessary).

Would you be prepared to give evidence of your use of the way
at a public inquiry or in a court of law, if necessary?

*YES/~~NO~~

Please note that this form may be available to members of the public including affected owners or occupiers of the land crossed by the way.

I certify that, to the best of my knowledge and belief, the information I have given to this statement is true.

Signature: PK

Person taking this statement (if applicable)

Date: 26.08.15

CONCLETON EDGE
← (TRACTOR GRAVEYARD)

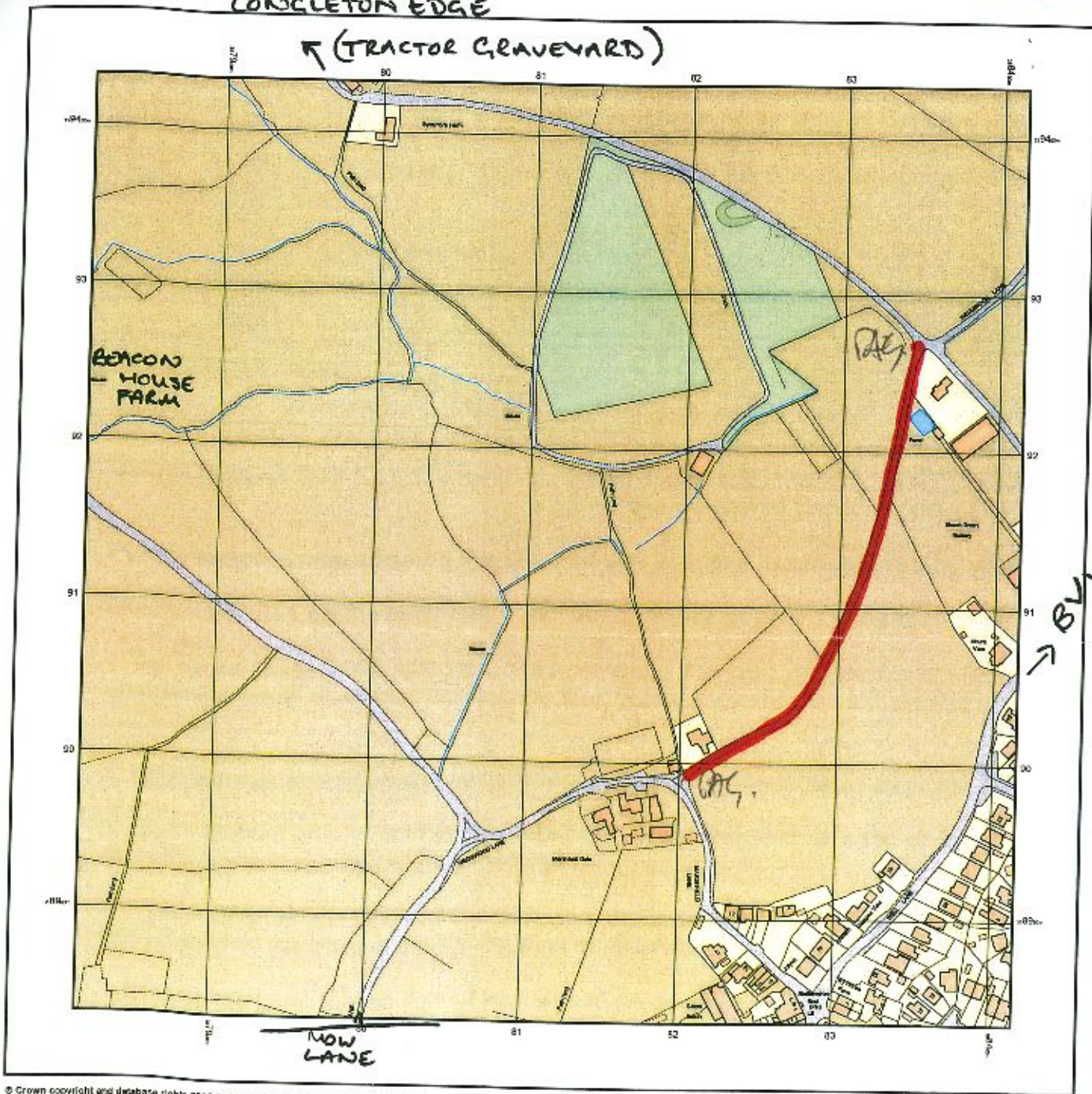

© Crown copyright and database rights 2015 Ordnance Survey 100048957. The representation of road, track or path is no evidence of a boundary or right of way. The representation of features as lines is no evidence of a property boundary.

Supplied by: www.ukmapcentre.com
Serial No: 76144
Centre Coordinates: 388115, 309133
Production Date: 17/08/2015 15:03:19

THE ROUTE HIGHLIGHTED RED IS THE ROUTE I HAVE USED

SIGNED..... *PAC* DATE *26.08.15*

Staffordshire

County Council

PUBLIC RIGHT OF WAY EVIDENCE FORM **Important Note**

The object of this enquiry is simply to reach the truth of the matter, whatever it may be. Witnesses are therefore asked to answer the questions as fully as possible and not to keep back any information, whether for or against the public status claim. This is of particular importance if the information is to be of real value in establishing the status of the way.

Name of witness (Mr/Mrs/Miss/Ms) W. ATKINSON
(Block Capitals please)

Please attach a map showing the claimed way marked in red, signed by yourself.

Guidance Notes on the completion of Public Rights of Way Evidence Forms

1. As far as possible the witness should complete the form, preferably in black ink. If another individual completes the form on their behalf they should indicate this at the end of the form.
2. Each witness should answer all questions fully with as much detail as possible.
3. Each witness should complete a separate form in respect of each claimed right of way about which she/he can give evidence.
4. A plan must be attached and the witness should clearly draw the route of the claimed right of way on the plan, and initial the plan at each end of the drawn route.
5. The route of the claimed right of way should be described as accurately as possible, if possible giving details of such things as property and field boundaries, stiles, gates, bridges and stepping stones, etc.
6. Witnesses should indicate whether they are prepared to give evidence either in a court or at a public inquiry. (The evidential value of a statement is reduced if it cannot be subject to cross examination).
7. If a witness would be unable to give evidence at a hearing because of ill health, age, etc the person obtaining the statement should endorse the form accordingly, and be able to give evidence of the circumstances.
8. The information given on this form may become available for public inspection.

Description of claimed way:- (include grid references if known)

From

To

Please take time to answer the questions carefully and in full

1. (a) How many years have you known the way? About 15 years
(b) Does the way have a popular name? Wedgwood Lane
(c) Have you personally used the above way? YES/NO
(d) Did you only use part of the way? YES/NO

Please do not use vague terms such as "often".

- (e) During which years have you used the way? From 2000 To Present
(f) Where were you going from/to? Valley Lane, Astbury; From + to
Puddlebank, Nick + Hill
(g) For what purpose? (eg work, pleasure) Pleasure
(h) How many times a year? (eg daily, weekly, seasonal) Weekly
(i) By what means? (eg on foot, horseback, motor vehicle etc) horseback, cycle
(j) Is, or was, the way a short cut for you?
(k) If so why?

(l) Please show on the attached plan the route of the way you have used.
If you have only used part of the way please mark or indicate the part used.

- (m) Do you still use the way? Occasionally
(n) If not why not?

2. When using the path where did you live? Initially in Leeds 2000-2007
currently in Congleton 2007 - Present
If at different places please provide details and years.

3. (a) How wide is the way? 3-4 metres
(b) Is it the same width throughout its length? No there are some narrower parts + it is obvious that it has been used
4. If you have ridden a horse on the way
(a) Where did you keep the horse? 1) The Astbury, Astbury Lane, Astbury
2) Puddlebank, Congleton Edge Road
(b) Where did you start and finish your ride? At the stables
(c) Were you ever riding with the hunt when you used the way? No

5. (a) When using the way did you ever see any other person driving motor or horse-drawn vehicles on the way? *YES/NO
- (b) If YES, how often and what type of vehicle were they using?
- (c) Have you ever driven, or been a passenger in, a motor or horse drawn vehicle on the way? *YES/NO
- (d) If YES to (c),
- (i) How often was this?
- (ii) What type of vehicle were you in?
- (iii) For what purpose was it being used?

6. (a) Has the way always been on the same route? *YES/NO
- (b) If NO, please describe the original route, state when the way was diverted and show details on a plan.
- (c) Is the way a clearly defined track or path which a stranger to the vicinity could follow? *Yes*
- (d) Have you always kept to the route of the way between the start and finish, or have you wandered from the route? *kept to the route as it was a well hedged edge*

7. (a) Have there, to your knowledge, ever been any stiles on the way? *YES/NO
- (b) Have there, to your knowledge, ever been any gates on the way? *YES/NO
- (c) If YES, please mark on the attached plan the location of the stiles or gates and state, if known, when they were erected or removed.
- (d) If any gates on the way were ever locked please state, how often, and if known, by whom?

Please mark on the attached plan the locations of the locked gates.

8. (a) Excluding locked gates, have you ever known of any other obstructions to the way? *YES/NO
- (b) If YES, state (i) what type of obstruction was this?
- (ii) When they were erected or removed?
- (c) Please state, if known, who erected the obstructions and show the approximate position of the obstructions on the attached plan.

9. Has your usage ever been hindered or prevented in any way? *YES/NO
- If so by whom or what?
- When was this?
- Have you continued to use the way despite hindrances or obstructions *YES/NO
- How did you do this? (e.g. diversion)
- Is the hindrance or obstruction still in existence *YES/NO
-

10. (a) Were you ever an owner or tenant of the land crossed by the way? *YES/NO

If YES, please give dates.

- (b) If you were an owner or tenant did you acknowledge the route as a Public Right of Way? *YES/NO

If YES, please give dates.

- (c) Was the land ever owned or tenanted by a relative of yours? *YES/NO

If so, what was their relationship to you?

- (d) When you used the way were you working for any owner or tenant of the land adjoining or crossed by the way? *YES/NO

(e) If YES to (d),

(i) What was your employment?

(ii) Between what years were you employed?

(f) If you were employed by the owner/tenant

(i) Did you receive any instructions from the owner/tenant as to the use of the way by the public? *YES/NO

(ii) If so, what were your instructions?

- (g) Did any relatives of yours ever work for an owner or tenant of land adjoining or crossed by the way? *YES/NO

If so, what was their relationship to you?

11. (a) Have you ever been stopped or turned back when using the way? *YES/NO

(b) Do you know, or have you heard of, anyone else having been prevented from using the way? *YES/NO

(c) If YES to (a) or (b), please give details including dates.

.....
.....

12. (a) Were you ever told by any owner or tenant of the land crossed by the way, or by anyone in their employment, that the way was not public? *YES/NO

(b) If YES, please state:

(i) Who told you?

(ii) When you were told?

(iii) What were you told?

13. (a) Have you ever seen any deterrent notices such as "Private", "No Road", "No Thoroughfare" or "Trespassers will be Prosecuted", on or near the way? *YES/NO

(b) If YES, please state what the notices said appropriate date of their display and show their approximate position on the attached plan? *YES/NO

14. (a) Have you ever seen any notices such as "Public Path", or "footpath", or any other similar notice on or near the way? *YES/NO

(b) Have you ever seen any direction signs, finger posts or other indicators on or near the way? *YES/NO

(c) If YES to (a) or (b), please state what the notices or posts said and show their approximate position on the attached plan?

.....

15. (a) Have you ever been given permission to use the way? *YES/NO
 (Whether or not you asked for it)
- (b) Have you ever asked permission to use the way? *YES/NO
- (c) If YES, who gave you permission?
- (d) When were you given permission?
- (e) For what purpose were you given permission to use the way?

16. (a) Have you seen other people using the way? *YES/NO
- (b) How were they using the way (ie foot, horse)? *Foot, bicycle, horse*
- (c) Were they accompanying you? If so, please give details. (ie companions, rambling club, family, etc)? *Some of them - Callie Dave Crowe, Andrea Benson, Sue Martin, Bottom Flagg, Maria Kowicz, Jane Cummins, Tracey Talbot, Joy Stone*
- (d) If they were not accompanying you, were these people known to you? *Yes, I know. There were regular users - eg the land owners at the corner of the lane.*
- (e) How frequently did you see other people using the way? (ie daily, weekly, seasonal etc) *Weekly*

- (f) How many other people, approximately, did you see on these occasions? *It was a popular route. I have seen groups of about 20 walkers and on a weekly basis at least I have known to see many school children.*
- (g) Please give any further details of other people's use of the way which you feel may be important. *You could not reach. South Downs Association, Conington, Jane Rofey, North Staffs. Sideways Ramblers Association*

17. Have you ever been charged a monetary sum for using the path? *YES/NO
 If so, by whom?

18. (a) Do you have any documentary evidence about the way? *YES/NO
- (b) If so, in what form is this? (ie maps, photos, etc please attach a copy if possible)
-
- (c) Would you be willing to make the original document available if necessary? *YES/NO

I have seen copies of historic documents with Wedgewood Lane on.

19. Can you give any further information about the way (continue on a separate sheet of paper if necessary).

Border Bridleways have regularly organised
8hr rides incorporating Wedgwood here
Celia Cromarty organised a he Treec competition
using this track

Initially I used the track as a visitiv from
herts ridig out with friends. It was part of
a regular ride that we used. When I moved
my horse from herts I regularly rode to
Wedgwood here as part of a number of routes
around the Biddulph Valley Trail. When I
moved my horse to Congleton Edge I continued
to use Wedgwood here as a regular ride. It
is an invaluable link to any number of local
routes which can extend as shorter rides.

I continue to use the track as a walker
and have found on my recent visit that
At Point this end to be well maintained however
the other end of the track is very overgrown +
the surface is in need of maintenance. I would
be concerned about riding my horse down
this part of the track.

20. Would you be prepared to give evidence of your use of the way at a public inquiry or in a court of law, if necessary?

YES/ NO

Please note that this form may be available to members of the public including affected owners or occupiers of the land crossed by the way.

I certify that, to the best of my knowledge and belief, the information I have given to this statement is true.

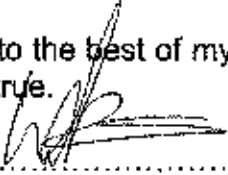
Signature: 

Person taking this statement (if applicable)

Date: 22 August 2015

CONGLETON EDGE
 (TRACTOR GRAVEYARD)

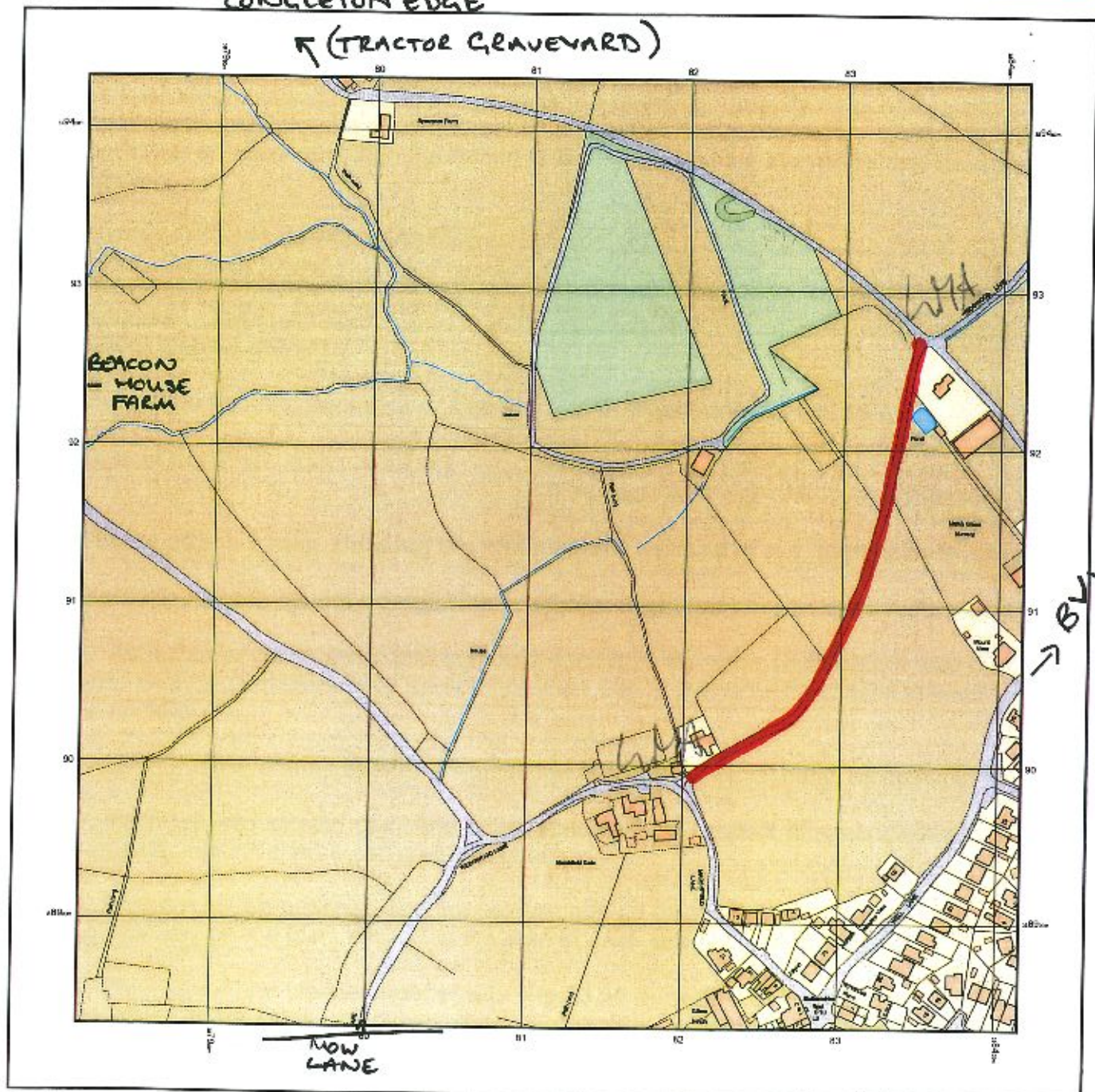

© Crown copyright and database rights 2015 Ordnance Survey 100041957. The representation of road, track or path is no evidence of a boundary or right of way. The representation of features as lines is no evidence of a property boundary.

Supplied by: www.ukmapcentre.com
 Serial No: 78144
 Centre Coordinates: 380115, 309133
 Production Date: 17/08/2015 15:05:19

THE ROUTE HIGHLIGHTED RED IS THE ROUTE I HAVE USED

SIGNED 

DATE 22 August 2015

Staffordshire

County Council

PUBLIC RIGHT OF WAY EVIDENCE FORM **Important Note**

The object of this enquiry is simply to reach the truth of the matter, whatever it may be. Witnesses are therefore asked to answer the questions as fully as possible and not to keep back any information, whether for or against the public status claim. This is of particular importance if the information is to be of real value in establishing the status of the way.

Name of witness (Mr/Mrs/Miss/Ms) MRS JULIE ANDREWS
(Block Capital letters)

Please attach a map showing the claimed way marked in red, signed by yourself.

Guidance Notes on the completion of Public Rights of Way Evidence Forms

1. As far as possible the witness should complete the form, preferably in black ink. If another individual completes the form on their behalf they should indicate this at the end of the form.
2. Each witness should answer all questions fully with as much detail as possible.
3. Each witness should complete a separate form in respect of each claimed right of way about which she/he can give evidence.
4. A plan must be attached and the witness should clearly draw the route of the claimed right of way on the plan, and initial the plan at each end of the drawn route.
5. The route of the claimed right of way should be described as accurately as possible, if possible giving details of such things as property and field boundaries, stiles, gates, bridges and stepping stones, etc.
6. Witnesses should indicate whether they are prepared to give evidence either in a court or at a public inquiry. (The evidential value of a statement is reduced if it cannot be subject to cross examination).
7. If a witness would be unable to give evidence at a hearing because of ill health, age, etc the person obtaining the statement should endorse the form accordingly, and be able to give evidence of the circumstances.
8. The information given on this form may become available for public inspection.

Description of claimed way:- (include grid references if known)

From

To

Please take time to answer the questions carefully and in full

1. (a) How many years have you known the way? 15 YEARS
(b) Does the way have a popular name? LEDGEWOOD LAVE
(c) Have you personally used the above way? YES *YES/NO
(d) Did you only use part of the way? NO - ALL THE TRACK *YES/NO

Please do not use vague terms such as "often".

- (e) During which years have you used the way? From 2000 To 2015
(f) Where were you going from/to? CONGLETON TO BIDDULPH VALLEY TRACK
(g) For what purpose? (eg work, pleasure) PLEASURE
(h) How many times a year? (eg daily, weekly, seasonal) WEEKLY
(i) By what means? (eg on foot, horseback, motor vehicle etc) HORSEBACK
(j) Is, or was, the way a short cut for you? YES
(k) If so why? USED HAS PART OF A CIRCULAR ROUTE FROM CONGLETON EDGE TO BIDDULPH VALLEY RAILWAY TRACK

(l) Please show on the attached plan the route of the way you have used.
If you have only used part of the way please mark or indicate the part used.

- (m) Do you still use the way? YES - WHEN NOT OVERTAKING
(n) If not why not?

2. When using the path where did you live? CONGLETON

If at different places please provide details and years.

3. (a) How wide is the way? AT TIMES HORSE WIDTH

(b) Is it the same width throughout its length? SOME PARTS

4. If you have ridden a horse on the way

(a) Where did you keep the horse? CONGLETON

(b) Where did you start and finish your ride? BEGINNING TO END OF TRACK
CONGLETON → CONGLETON

(c) Were you ever riding with the hunt when you used the way? NO

5. (a) When using the way did you ever see any other person driving motor or horse-drawn vehicles on the way? **NO** *YES/NO
- (b) If **YES**, how often and what type of vehicle were they using? **N/A**
- (c) Have you ever driven, or been a passenger in, a motor or horse drawn vehicle on the way? **NO** *YES?NO
- (d) If **YES** to (c),
- (i) How often was this?
- (ii) What type of vehicle were you in?
- (iii) For what purpose was it being used?

6. (a) Has the way always been on the same route? **YES** *YES/NO
- (b) If **NO**, please describe the original route, state when the way was diverted and show details on a plan.
- (c) Is the way a clearly defined track or path which a stranger to the vicinity could follow?
- (d) Have you always kept to the route of the way between the start and finish, or have you wandered from the route?

7. (a) Have there, to your knowledge, ever been any stiles on the way? **NO** *YES/NO
- (b) Have there, to your knowledge, ever been any gates on the way **NO** *YES/NO
- (c) If **YES**, please mark on the attached plan the location of the stiles or gates and state, if known, when they were erected or removed.
- (d) If any gates on the way were ever locked please state, how often, and if known, by whom?
- Please mark on the attached plan the locations of the locked gates.

8. (a) Excluding locked gates, have you ever known of any other obstructions to the way? **YES** *YES/NO
- (b) If **YES**, state (i) what type of obstruction was this? **OVERGROWN HEDGES + PATH FLOOR UNEVEN**
- (ii) When they were erected or removed?
- (c) Please state, if known, who erected the obstructions and show the approximate position of the obstructions on the attached plan. **NO**

9. Has your usage ever been hindered or prevented in any way? *YES/NO

If so by whom or what? YES.....

When was this? HEDGES TO OVERGROWN, + PATH COULD NOT SEE WHERE GOING.....

Have you continued to use the way despite hindrances or obstructions *YES/NO
SOMETIMES

How did you do this? (e.g. diversion)

Is the hindrance or obstruction still in existence YES CAN BE *YES/NO

10. (a) Were you ever an owner or tenant of the land crossed by the way? *YES/NO

NO

If YES, please give dates.

(b) If you were an owner or tenant did you acknowledge the route as a Public Right of Way? NO *YES/NO

If YES, please give dates.

(c) Was the land ever owned or tenanted by a relative of yours? NO *YES/NO

If so, what was their relationship to you?

(d) When you used the way were you working for any owner or tenant of the land adjoining or crossed by the way? NO *YES/NO

(e) If YES to (d),

(i) What was your employment?

(ii) Between what years were you employed?

(f) If you were employed by the owner/tenant

(i) Did you receive any instructions from the owner/tenant as to the use of the way by the public? NIA *YES/NO

(ii) If so, what were your instructions?

(g) Did any relatives of yours ever work for an owner or tenant of land adjoining or crossed by the way? NIA *YES/NO

If so, what was their relationship to you?

11. (a) Have you ever been stopped or turned back when using the way? *YES/NO

YES

(b) Do you know, or have you heard of, anyone else having been prevented from using the way? *YES/NO

YES

(c) If YES to (a) or (b), please give details including dates.

VARIOUS TIMES THROUGHOUT THE YEARS DUE TO BEING NOT SAFE TO RIDE A HORSE DOWN THE TRACK

12. (a) Were you ever told by any owner or tenant of the land crossed by the way, or by anyone in their employment, that the way was not public? *YES/NO

NO

(b) If YES, please state:

(i) Who told you?

(ii) When you were told?

(iii) What were you told?

13. (a) Have you ever seen any deterrent notices such as "Private", "No Road", "No Thoroughfare" or "Trespassers will be Prosecuted", on or near the way? *YES/NO

NO

(b) If YES, please state what the notices said appropriate date of their display and show their approximate position on the attached plan? *YES/NO

14. (a) Have you ever seen any notices such as "Public Path", or "footpath", or any other similar notice on or near the way? *YES/NO

NO

(b) Have you ever seen any direction signs, finger posts or other indicators on or near the way? *YES/NO

NO

(c) If YES to (a) or (b), please state what the notices or posts said and show their approximate position on the attached plan?

.....

15. (a) Have you ever been given permission to use the way? *YES/NO
(Whether or not you asked for it)
- (b) Have you ever asked permission to use the way? *YES/NO
- (c) If YES, who gave you permission?
- (d) When were you given permission?
- (e) For what purpose were you given permission to use the way?
-

16. (a) Have you seen other people using the way? YES *YES/NO
- (b) How were they using the way (ie foot, horse)? HORSE + FOOT, CYCLIST.....
- (c) Were they accompanying you? If so, please give details. (ie companions, rambling club, family, etc)? NO.....
- (d) If they were not accompanying you, were these people known to you? NO.....
- (e) How frequently did you see other people using the way? (ie daily, weekly, seasonal etc) WEEKLY.....
- (f) How many other people, approximately, did you see on these occasions? COUPLE
- (g) Please give any further details of other people's use of the way which you feel may be important
-

17. Have you ever been charged a monetary sum for using the path? *YES/NO
If so, by whom? NO
-

18. (a) Do you have any documentary evidence about the way? NO *YES/NO
- (b) If so, in what form is this? ie maps, photos, etc please attach a copy if possible)
.....
- (c) Would you be willing to make the original document available if necessary? N/A *YES/NO

19. Can you give any further information about the way (continue on a separate sheet of paper if necessary).

20. Would you be prepared to give evidence of your use of the way
at a public inquiry or in a court of law, if necessary? YES *YES/NO

Please note that this form may be available to members of the public including affected owners or occupiers of the land crossed by the way.

I certify that, to the best of my knowledge and belief, the information I have given to this statement is true.

Signature: J. Andrews

Person taking this statement (if applicable) JULIE ANDREWS

Date: 6-10-15

CONCLETON EDGE
← (TRACTOR GRAVEYARD)

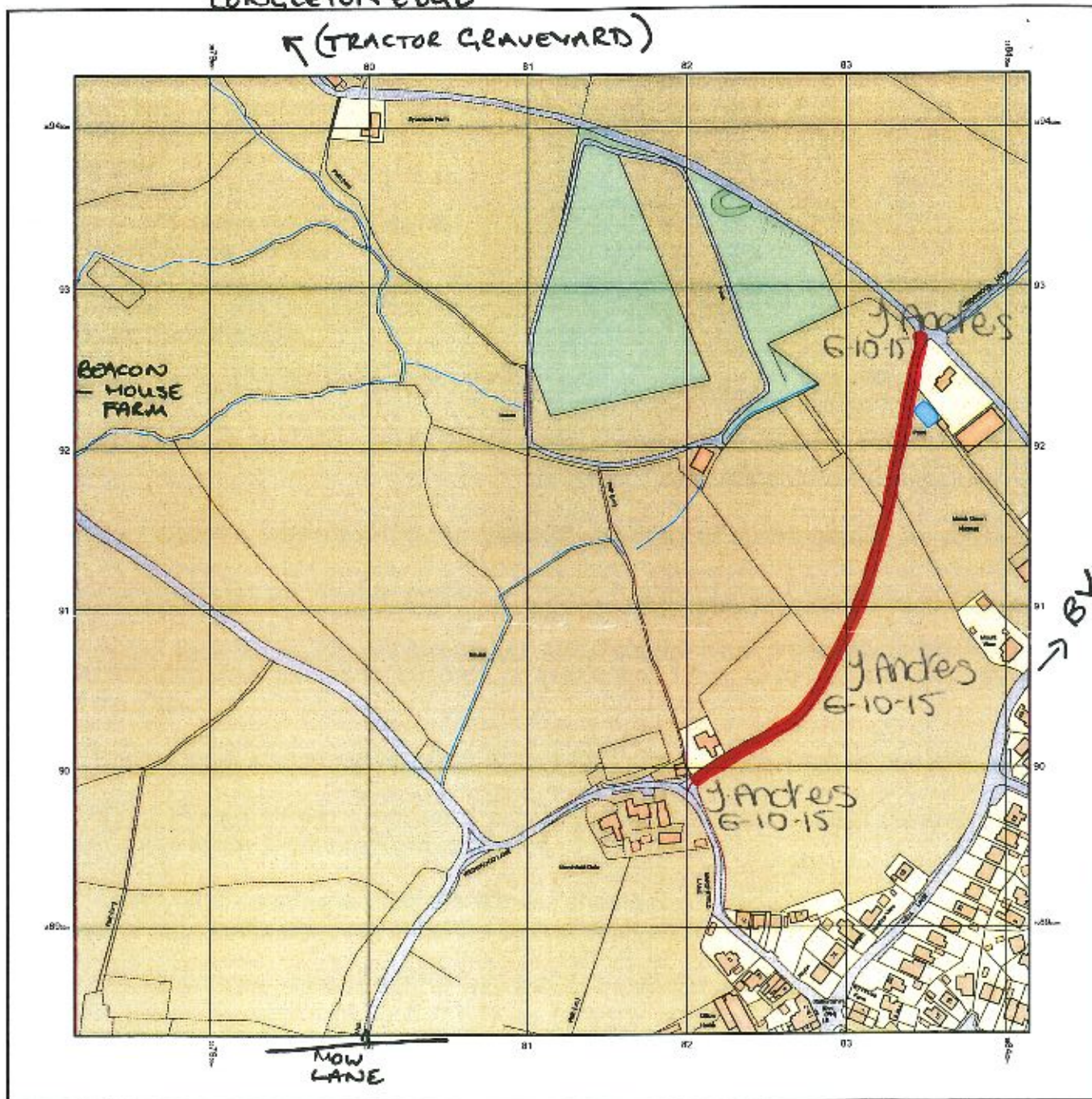

© Crown copyright and database rights 2015 Ordnance Survey 100048957. The representation of road, track or path is no evidence of a boundary or right of way. The representation of features as lines is no evidence of a property boundary.

Supplied by: www.ukmapcentre.com
Serial No: 76144
Centre Coordinates: 388115.399133
Production Date: 17/08/2015 15:05:19

THE ROUTE HIGHLIGHTED RED IS THE ROUTE I HAVE USED

SIGNED J. Andres DATE 6-10-15

Staffordshire

County Council

PUBLIC RIGHT OF WAY EVIDENCE FORM

Important Note

The object of this enquiry is simply to reach the truth of the matter, whatever it may be. Witnesses are therefore asked to answer the questions as fully as possible and not to keep back any information, whether for or against the public status claim. This is of particular importance if the information is to be of real value in establishing the status of the way.

Name of witness (Mr/Mrs/Miss/Ms) SANDRE JACKSON

Please attach a map showing the claimed way marked in red, signed by yourself.

Guidance Notes on the completion of Public Rights of Way Evidence Forms

1. As far as possible the witness should complete the form, preferably in black ink. If another individual completes the form on their behalf they should indicate this at the end of the form.
2. Each witness should answer all questions fully with as much detail as possible.
3. Each witness should complete a separate form in respect of each claimed right of way about which she/he can give evidence.
4. A plan must be attached and the witness should clearly draw the route of the claimed right of way on the plan, and initial the plan at each end of the drawn route.
5. The route of the claimed right of way should be described as accurately as possible, if possible giving details of such things as property and field boundaries, stiles, gates, bridges and stepping stones, etc.
6. Witnesses should indicate whether they are prepared to give evidence either in a court or at a public inquiry. (The evidential value of a statement is reduced if it cannot be subject to cross examination).
7. If a witness would be unable to give evidence at a hearing because of ill health, age, etc the person obtaining the statement should endorse the form accordingly, and be able to give evidence of the circumstances.
8. The information given on this form may become available for public inspection.

Description of claimed way:- (include grid references if known)

From

To

Please take time to answer the questions carefully and in full

1. (a) How many years have you known the way? 15 years
(b) Does the way have a popular name?
(c) Have you personally used the above way? *YES/NO
(d) Did you only use part of the way? *YES/NO

Please do not use vague terms such as "often".

- (e) During which years have you used the way? From 2000 To 2015
(f) Where were you going from/to? GILLOW HEATH + CONELTON EDGE
(g) For what purpose? (eg work, pleasure) PLEASURE
(h) How many times a year? (eg daily, weekly, seasonal) MONTHLY
(i) By what means? (eg on foot, horseback, motor vehicle etc) HORSEBACK + ON FOOT
(j) Is, or was, the way a short cut for you? NO
(k) If so why?

(l) Please show on the attached plan the route of the way you have used.
If you have only used part of the way please mark or indicate the part used.

- (m) Do you still use the way? YES
(n) If not why not? -

2. When using the path where did you live? 10 KESTREL CLOSE CONELTON
If at different places please provide details and years.

3. (a) How wide is the way? NOT SURE
(b) Is it the same width throughout its length?

4. If you have ridden a horse on the way
(a) Where did you keep the horse? MORTON LIVERY
(b) Where did you start and finish your ride? GILLOW HEATH.
(c) Were you ever riding with the hunt when you used the way? NO

5. (a) When using the way did you ever see any other person driving motor or horse-drawn vehicles on the way? *YES/NO
- (b) If YES, how often and what type of vehicle were they using?
- (c) Have you ever driven, or been a passenger in, a motor or horse drawn vehicle on the way? *YES/NO
- (d) If YES to (c),
- (i) How often was this?
- (ii) What type of vehicle were you in?
- (iii) For what purpose was it being used?

6. (a) Has the way always been on the same route? *YES/NO
- (b) If NO, please describe the original route, state when the way was diverted and show details on a plan.
- (c) Is the way a clearly defined track or path which a stranger to the vicinity could follow? YES
- (d) Have you always kept to the route of the way between the start and finish, or have you wandered from the route? NO

7. (a) Have there, to your knowledge, ever been any stiles on the way? *YES/NO
- (b) Have there, to your knowledge, ever been any gates on the way? *YES/NO
- (c) If YES, please mark on the attached plan the location of the stiles or gates and state, if known, when they were erected or removed.
- (d) If any gates on the way were ever locked please state, how often, and if known, by whom?
- Please mark on the attached plan the locations of the locked gates.

8. (a) Excluding locked gates, have you ever known of any other obstructions to the way? *YES/NO
- (b) If YES, state (i) what type of obstruction was this?
- (ii) When they were erected or removed?
- (c) Please state, if known, who erected the obstructions and show the approximate position of the obstructions on the attached plan.

9. Has your usage ever been hindered or prevented in any way? *YES/NO

If so by whom or what?

When was this?

Have you continued to use the way despite hindrances or obstructions *YES/NO

How did you do this? (e.g. diversion)

Is the hindrance or obstruction still in existence *YES/NO

10. (a) Were you ever an owner or tenant of the land crossed by the way? *YES/NO

If YES, please give dates.

(b) If you were an owner or tenant did you acknowledge the route as a Public Right of Way? *YES/NO

If YES, please give dates.

(c) Was the land ever owned or tenanted by a relative of yours? *YES/NO

If so, what was their relationship to you?

(d) When you used the way were you working for any owner or tenant of the land adjoining or crossed by the way? *YES/NO

(e) If YES to (d),

(i) What was your employment?

(ii) Between what years were you employed?

(f) If you were employed by the owner/tenant

(i) Did you receive any instructions from the owner/tenant as to the use of the way by the public? *YES/NO

(ii) If so, what were your instructions?

(g) Did any relatives of yours ever work for an owner or tenant of land adjoining or crossed by the way? *YES/NO

If so, what was their relationship to you?

11. (a) Have you ever been stopped or turned back when using the way? *YES/NO

(b) Do you know, or have you heard of, anyone else having been prevented from using the way? *YES/NO

(c) If YES to (a) or (b), please give details including dates.

.....
.....

12. (a) Were you ever told by any owner or tenant of the land crossed by the way, or by anyone in their employment, that the way was not public? *YES/NO

(b) If YES, please state:

(i) Who told you?

(ii) When you were told?

(iii) What were you told?

13. (a) Have you ever seen any deterrent notices such as "Private", "No Road", "No Thoroughfare" or "Trespassers will be Prosecuted", on or near the way? *YES/NO

(b) If YES, please state what the notices said appropriate date of their display and show their approximate position on the attached plan? *YES/NO

14. (a) Have you ever seen any notices such as "Public Path", or "footpath", or any other similar notice on or near the way? *YES/NO

(b) Have you ever seen any direction signs, finger posts or other indicators on or near the way? *YES/NO

(c) If YES to (a) or (b), please state what the notices or posts said and show their approximate position on the attached plan?

.....

15. (a) Have you ever been given permission to use the way?
(Whether or not you asked for it) *YES/NO
- (b) Have you ever asked permission to use the way? *YES/NO
- (c) If YES, who gave you permission?
- (d) When were you given permission?
- (e) For what purpose were you given permission to use the way?
-

16. (a) Have you seen other people using the way? YES/NO
- (b) How were they using the way (ie foot, horse)? Horse & on foot
- (c) Were they accompanying you? If so, please give details. (ie companions, rambling club, family, etc)? Running Club + Companions
- (d) If they were not accompanying you, were these people known to you?
- (e) How frequently did you see other people using the way? (ie daily, weekly, seasonal etc) monthly
- (f) How many other people, approximately, did you see on these occasions? 3
- (g) Please give any further details of other people's use of the way which you feel may be important
-

17. Have you ever been charged a monetary sum for using the path?
If so, by whom? *YES/NO
-

18. (a) Do you have any documentary evidence about the way? *YES/NO
- (b) If so, in what form is this? ie maps, photos, etc please attach a copy if possible
.....
- (c) Would you be willing to make the original document available if necessary? *YES/NO

19. Can you give any further information about the way (continue on a separate sheet of paper if necessary).

20. Would you be prepared to give evidence of your use of the way at a public inquiry or in a court of law, if necessary?

YES NO

Please note that this form may be available to members of the public including affected owners or occupiers of the land crossed by the way.

I certify that, to the best of my knowledge and belief, the information I have given to this statement is true.

Signature: 

Person taking this statement (if applicable)

Date: 8/9/15

CONGLETON EDGE
← (TRACTOR GRAVEYARD)

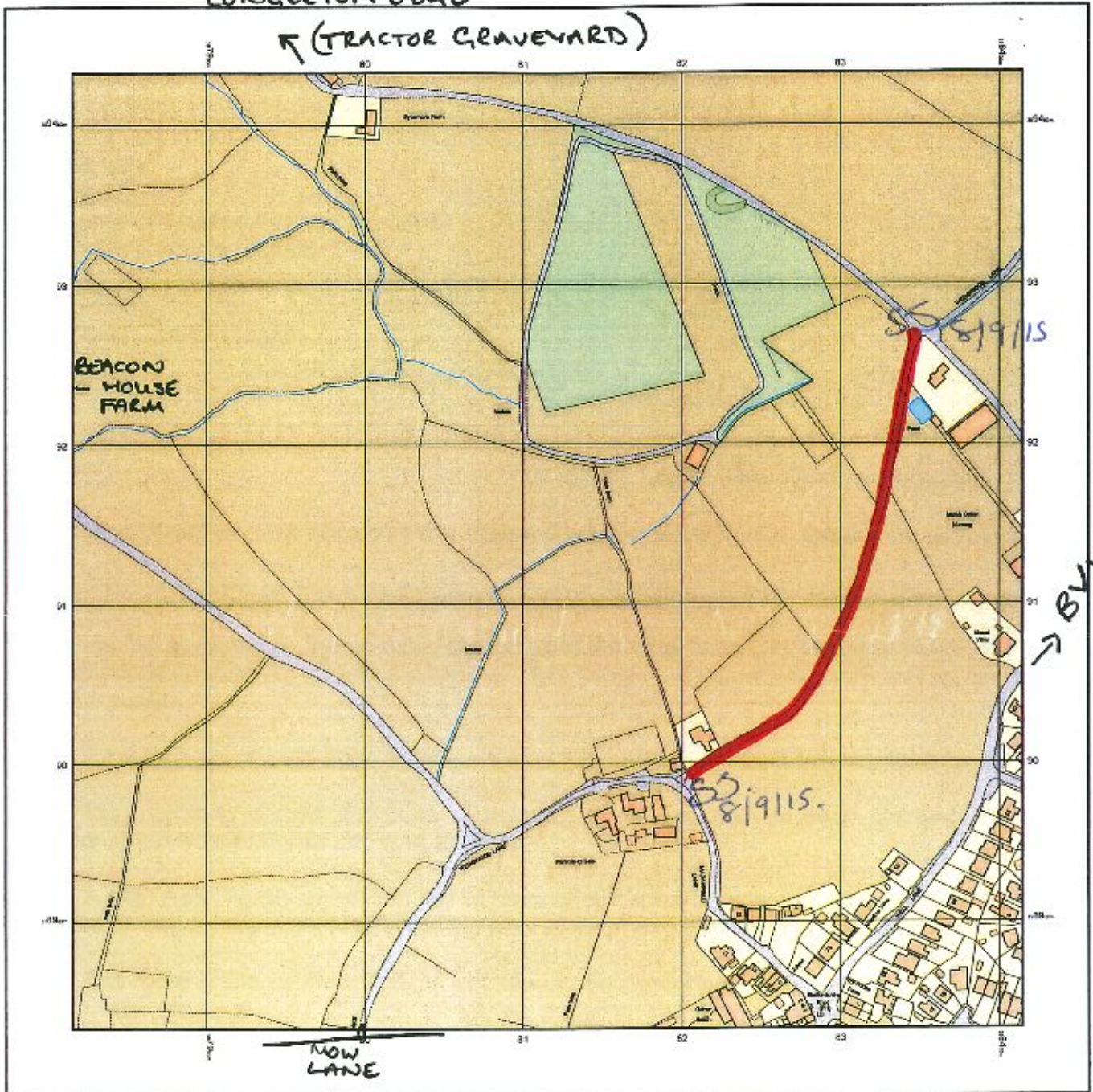

© Crown copyright and database rights 2015 Ordnance Survey 100048967. The representation of road, track or path is no evidence of a boundary or right of way. The representation of features as lines is no evidence of a property boundary.

THE ROUTE HIGHLIGHTED RED IS THE ROUTE I HAVE USED

SIGNED..... *[Signature]* DATE *8/9/15*

Staffordshire

County Council

PUBLIC RIGHT OF WAY EVIDENCE FORM **Important Note**

The object of this enquiry is simply to reach the truth of the matter, whatever it may be. Witnesses are therefore asked to answer the questions as fully as possible and not to keep back any information, whether for or against the public status claim. This is of particular importance if the information is to be of real value in establishing the status of the way.

Name of witness (Mr/Mrs/Miss/Ms) RACHEL MARGARET STAFFORD
(Block Capitals please)

Please attach a map showing the claimed way marked in red, signed by yourself.

Guidance Notes on the completion of Public Rights of Way Evidence Forms

1. As far as possible the witness should complete the form, preferably in black ink. If another individual completes the form on their behalf they should indicate this at the end of the form.
2. Each witness should answer all questions fully with as much detail as possible.
3. Each witness should complete a separate form in respect of each claimed right of way about which she/he can give evidence.
4. A plan must be attached and the witness should clearly draw the route of the claimed right of way on the plan, and initial the plan at each end of the drawn route.
5. The route of the claimed right of way should be described as accurately as possible, if possible giving details of such things as property and field boundaries, stiles, gates, bridges and stepping stones, etc.
6. Witnesses should indicate whether they are prepared to give evidence either in a court or at a public inquiry. (The evidential value of a statement is reduced if it cannot be subject to cross examination).
7. If a witness would be unable to give evidence at a hearing because of ill health, age, etc the person obtaining the statement should endorse the form accordingly, and be able to give evidence of the circumstances.
8. The information given on this form may become available for public inspection.

Description of claimed way:- (include grid references if known)

From

To

Please take time to answer the questions carefully and in full

1. (a) How many years have you known the way? 15 YEARS
(b) Does the way have a popular name?
(c) Have you personally used the above way? *YES/NO
(d) Did you only use part of the way? *YES/NO

Please do not use vague terms such as "often".

- (e) During which years have you used the way? From 2000 To 2015
(f) Where were you going from/to? PUBLIC BRIDLEWAY 79 TO MARSHFIELD ROAD
(g) For what purpose? (eg work, pleasure) PLEASURE
(h) How many times a year? (eg daily, weekly, seasonal) WEEKLY / MONTHLY
(i) By what means? (eg on foot, horseback, motor vehicle etc) HORSEBACK
(j) Is, or was, the way a short cut for you? NO
(k) If so why?

(l) Please show on the attached plan the route of the way you have used.
If you have only used part of the way please mark or indicate the part used.

- (m) Do you still use the way? YES
(n) If not why not?

2. When using the path where did you live? 2007 - 2015 PRESENT HOME ADDRESS AND 33 CROSS LANE, CONGLETON CW12 3TX 2000 - 2007
If at different places please provide details and years.

3. (a) How wide is the way? 6 FT APPROX
(b) Is it the same width throughout its length? NO

4. If you have ridden a horse on the way
(a) Where did you keep the horse? HOME ADDRESS
(b) Where did you start and finish your ride? HOME ADDRESS
(c) Were you ever riding with the hunt when you used the way? NO

5. (a) When using the way did you ever see any other person driving motor or horse-drawn vehicles on the way? *YES/NO
- (b) If YES, how often and what type of vehicle were they using?
- (c) Have you ever driven, or been a passenger in, a motor or horse drawn vehicle on the way? *YES?NO
- (d) If YES to (c),
- (i) How often was this?
- (ii) What type of vehicle were you in?
- (iii) For what purpose was it being used?
-

6. (a) Has the way always been on the same route? *YES/NO
- (b) If NO, please describe the original route, state when the way was diverted and show details on a plan.
- (c) Is the way a clearly defined track or path which a stranger to the vicinity could follow? YES
- (d) Have you always kept to the route of the way between the start and finish, or have you wandered from the route? NO NEVER WANDERED OFF ROUTE
ALWAYS KEPT TO ROUTE
-

7. (a) Have there, to your knowledge, ever been any stiles on the way? *YES/NO
- (b) Have there, to your knowledge, ever been any gates on the way *YES/NO
- (c) If YES, please mark on the attached plan the location of the stiles or gates and state, if known, when they were erected or removed.
- (d) If any gates on the way were ever locked please state, how often, and if known, by whom?
- Please mark on the attached plan the locations of the locked gates.
-

8. (a) Excluding locked gates, have you ever known of any other obstructions to the way? *YES/NO
- (b) If YES, state (i) what type of obstruction was this?
- (ii) When they were erected or removed?
- (c) Please state, if known, who erected the obstructions and show the approximate position of the obstructions on the attached plan.

9. Has your usage ever been hindered or prevented in any way? *~~YES~~/NO
If so by whom or what?
When was this?
Have you continued to use the way despite hindrances or obstructions *YES/NO
How did you do this? (e.g. diversion)
Is the hindrance or obstruction still in existence *YES/NO

10. (a) Were you ever an owner or tenant of the land crossed by the way? *~~YES~~/NO

If YES, please give dates.

(b) If you were an owner or tenant did you acknowledge the route as a Public Right of Way? *YES/NO

If YES, please give dates.

(c) Was the land ever owned or tenanted by a relative of yours? *~~YES~~/NO

If so, what was their relationship to you?

(d) When you used the way were you working for any owner or tenant of the land adjoining or crossed by the way? *~~YES~~/NO

(e) If YES to (d),

(i) What was your employment?

(ii) Between what years were you employed?

(f) If you were employed by the owner/tenant

(i) Did you receive any instructions from the owner/tenant as to the use of the way by the public? *YES/NO

(ii) **If so**, what were your instructions?

(g) Did any relatives of yours ever work for an owner or tenant of land adjoining or crossed by the way? *~~YES~~/NO

If so, what was their relationship to you?

11. (a) Have you ever been stopped or turned back when using the way? *YES/NO
- (b) Do you know, or have you heard of, anyone else having been prevented from using the way? *YES/NO

(c) If YES to (a) or (b), please give details including dates.

.....

.....

-
12. (a) Were you ever told by any owner or tenant of the land crossed by the way, or by anyone in their employment, that the way was not public? *YES/NO

(b) If YES, please state:

- (i) Who told you?
- (ii) When you were told?
- (iii) What were you told?

-
13. (a) Have you ever seen any deterrent notices such as "Private", "No Road", "No Thoroughfare" or "Trespassers will be Prosecuted", on or near the way? *YES/NO

(b) If YES, please state what the notices said appropriate date of their display and show their approximate position on the attached plan? *YES/NO

-
14. (a) Have you ever seen any notices such as "Public Path", or "footpath", or any other similar notice on or near the way? *YES/NO

(b) Have you ever seen any direction signs, finger posts or other indicators on or near the way? *YES/NO

(c) If YES to (a) or (b), please state what the notices or posts said and show their approximate position on the attached plan?

.....

15. (a) Have you ever been given permission to use the way? ~~YES~~/NO
(Whether or not you asked for it)
- (b) Have you ever asked permission to use the way? *~~YES~~/NO
- (c) If YES, who gave you permission?
- (d) When were you given permission?
- (e) For what purpose were you given permission to use the way?
-

16. (a) Have you seen other people using the way? *YES/~~NO~~
- (b) How were they using the way (ie foot, horse)? ...HORSE.....FOOT.....
- (c) Were they accompanying you? If so, please give details. (ie companions, rambling club, family, etc)?FAMILY,.....FRIENDS.....
- (d) If they were not accompanying you, were these people known to you? ...N.O..
- (e) How frequently did you see other people using the way? (ie daily, weekly, seasonal etc)ONCE / TWICE.....A MONTH.....
- (f) How many other people, approximately, did you see on these occasions? .1/.2
- (g) Please give any further details of other people's use of the way which you feel may be important
-

17. Have you ever been charged a monetary sum for using the path? ~~YES~~/NO
If so, by whom?
-

18. (a) Do you have any documentary evidence about the way? ~~YES~~/NO
- (b) If so, in what form is this? ie maps, photos, etc please attach a copy if possible)
.....
- (c) Would you be willing to make the original document available if necessary? *YES/NO

19. Can you give any further information about the way (continue on a separate sheet of paper if necessary).

20. Would you be prepared to give evidence of your use of the way
at a public inquiry or in a court of law, if necessary?

*YES/NO

Please note that this form may be available to members of the public including affected owners or occupiers of the land crossed by the way.

I certify that, to the best of my knowledge and belief, the information I have given to this statement is true.

Signature: *R.M. Stafford*

Person taking this statement (if applicable)

Date: *25/8/15*

CONGLETON EDGE

↑ (TRACTOR GRAVEYARD)

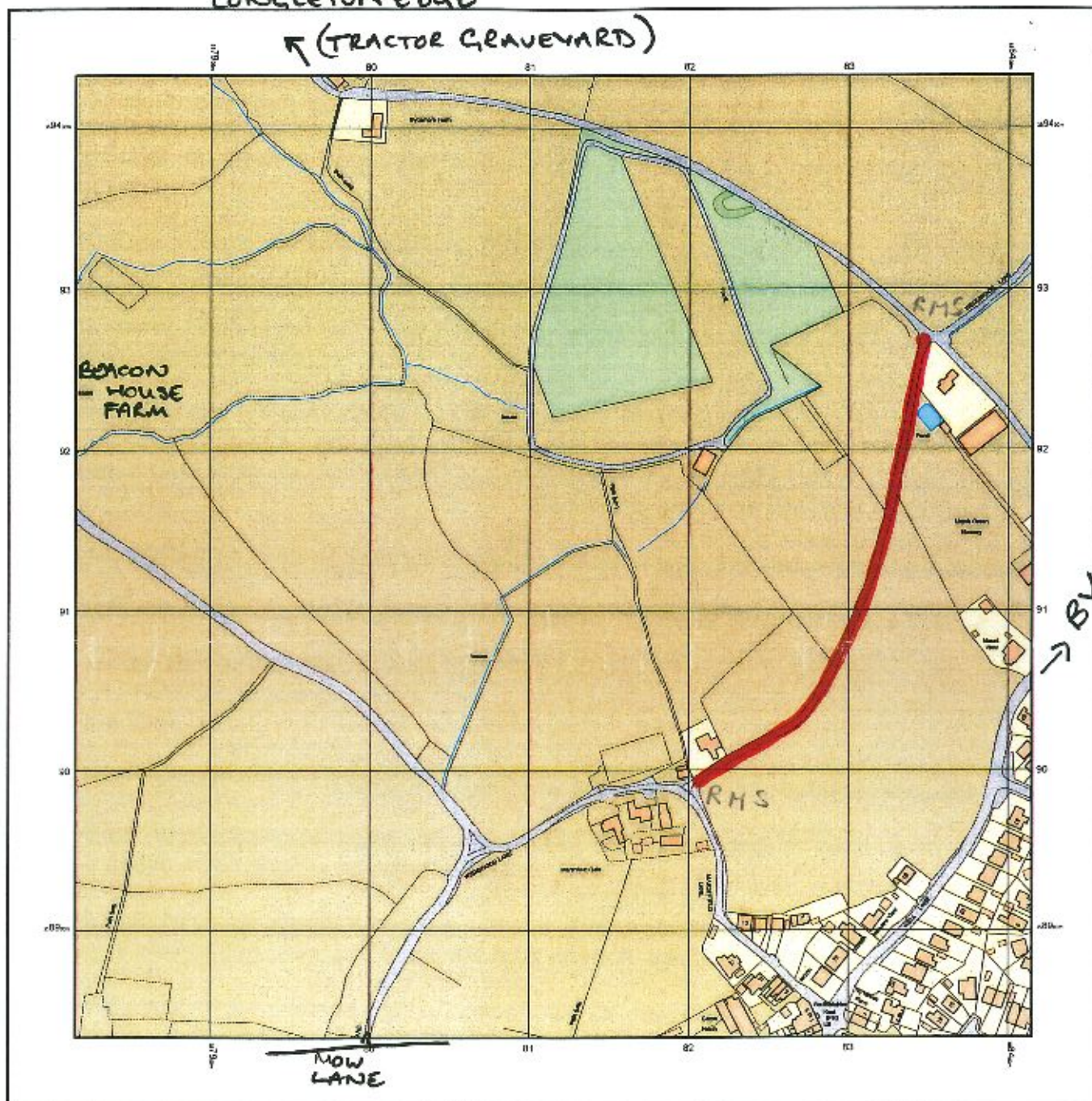

© Crown copyright and database rights 2015 Ordnance Survey 100068857. The representation of road, track or path is no evidence of a boundary or right of way. The representation of features as lines is no evidence of a property boundary.

Supplied by: www.ukmapcentre.com
Serial No: 75144
Centre Coordinates: 080115, 358133
Production Date: 17/08/2015 15:05:19

THE ROUTE HIGHLIGHTED RED IS THE ROUTE I HAVE USED

SIGNED R.M. Stafford DATE 25/8/15